

SITE PLAN OF PLOT NO. AC-

AT AMBEDKAR ROAD, DISTT. CENTRE GZB

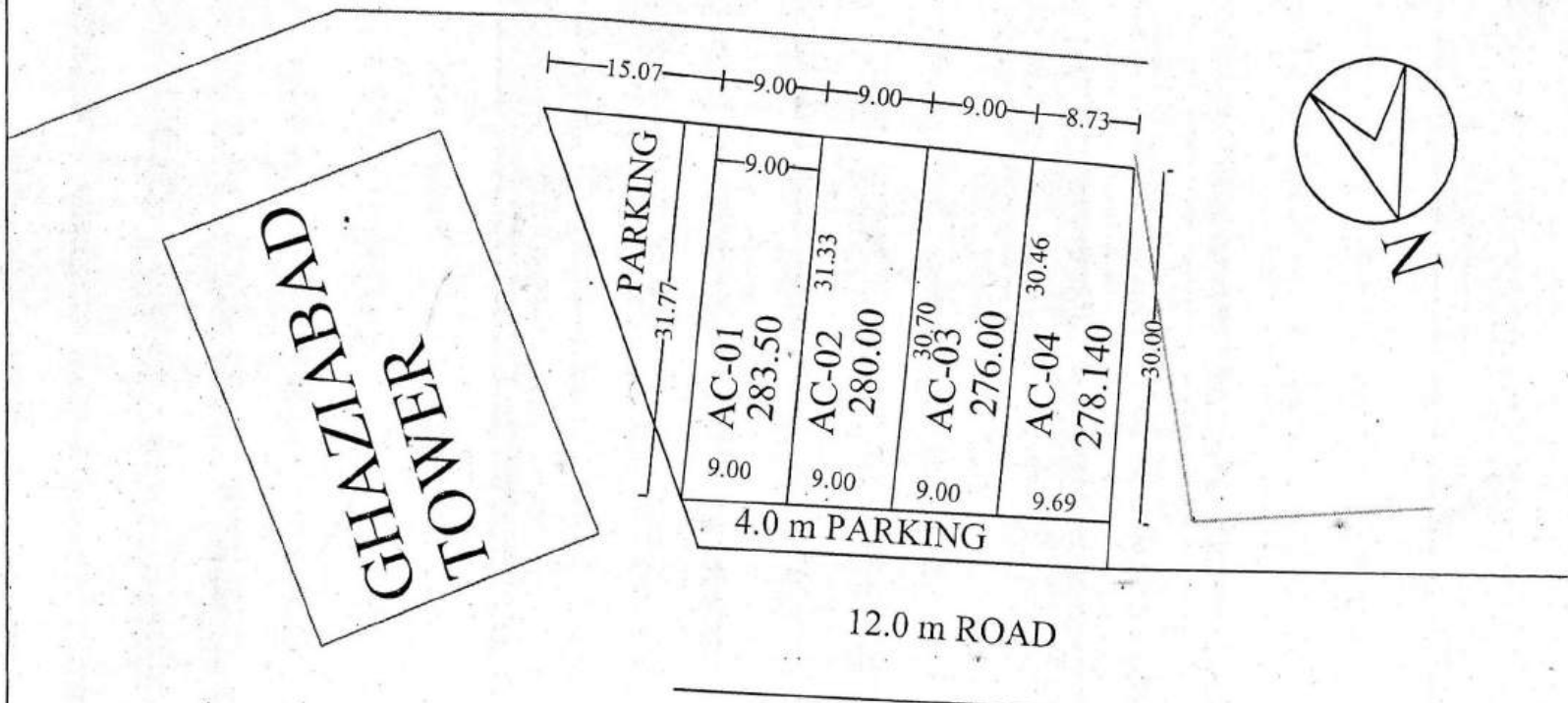

*[Signature]*  
31/03/10

PREPARED By.

COMPARED By.

*[Signature]*  
31/3/10

Measured By.

*[Signature]*  
31.03.10

Astt. Engineer

*[Signature]*  
07/4/10

Town Planner.

SITE PLAN OF PLOT NO. AC-06 AT AMBEDKAR ROAD, DISTT. CENTRE GZB

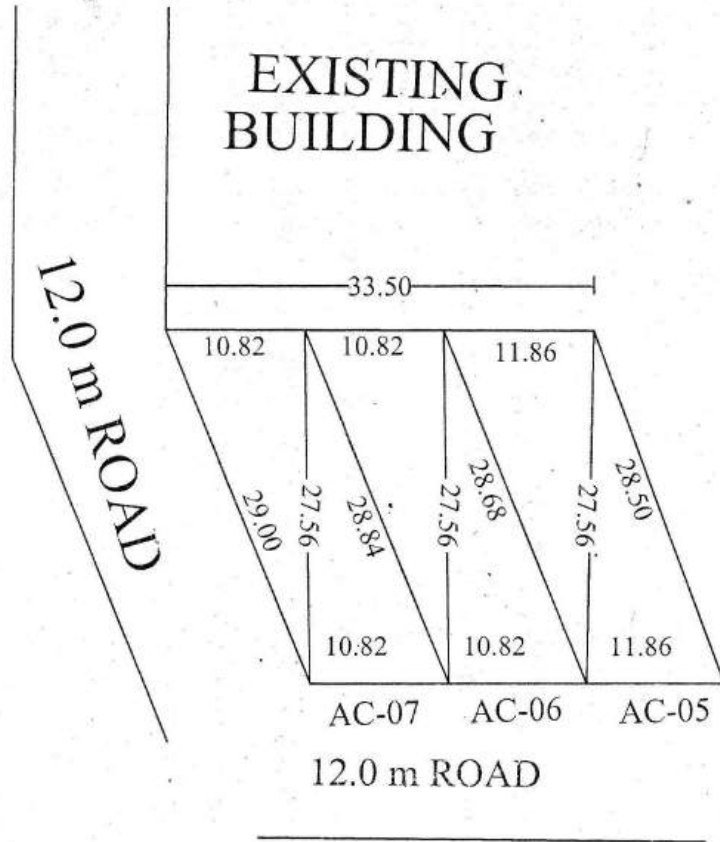

PLOT NO.	AREA
AC-05	311.03 SQ.M
AC-06	296.64 SQ.M
AC-07	296.97 SQ.M

*[Signature]*  
88/03/12.  
PREPARED By.

*[Signature]*  
27/3/12  
COMPARED By.

*[Signature]*  
20/3/12  
Measured By.

*[Signature]*  
26/03/12  
Astt. Engineer

*[Signature]*  
27/3/12  
Town Planner.

SITE PLAN OF PLOT NO. AC-

AT AMBEDKAR ROAD, DISTT. CENTRE GZB

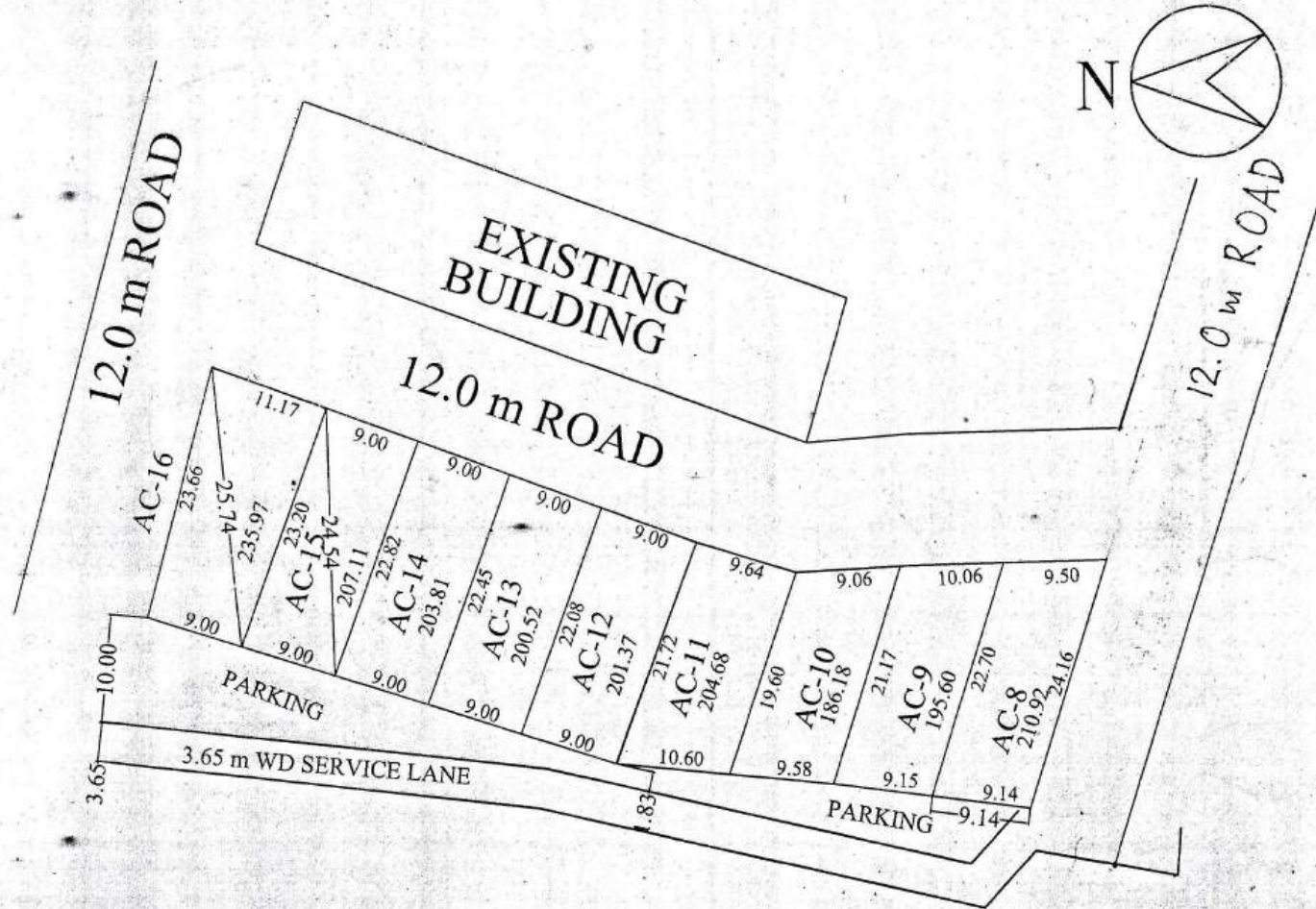

PREPARED By. *[Signature]*  
29/12/08

COMPARED By. *[Signature]*  
29-12-08

Measured By. *[Signature]*

*[Signature]*  
29.12.08  
Asth. Engineer

*[Signature]*  
29/12/08  
A.T.P.

*[Signature]*  
29/12/08  
E.E.

*[Signature]*  
29/12/08  
Town Planner.

SITE PLAN FOR COMMERCIAL PLOT NO. AT AMBEDKAR ROAD, DISTT. CENTRE

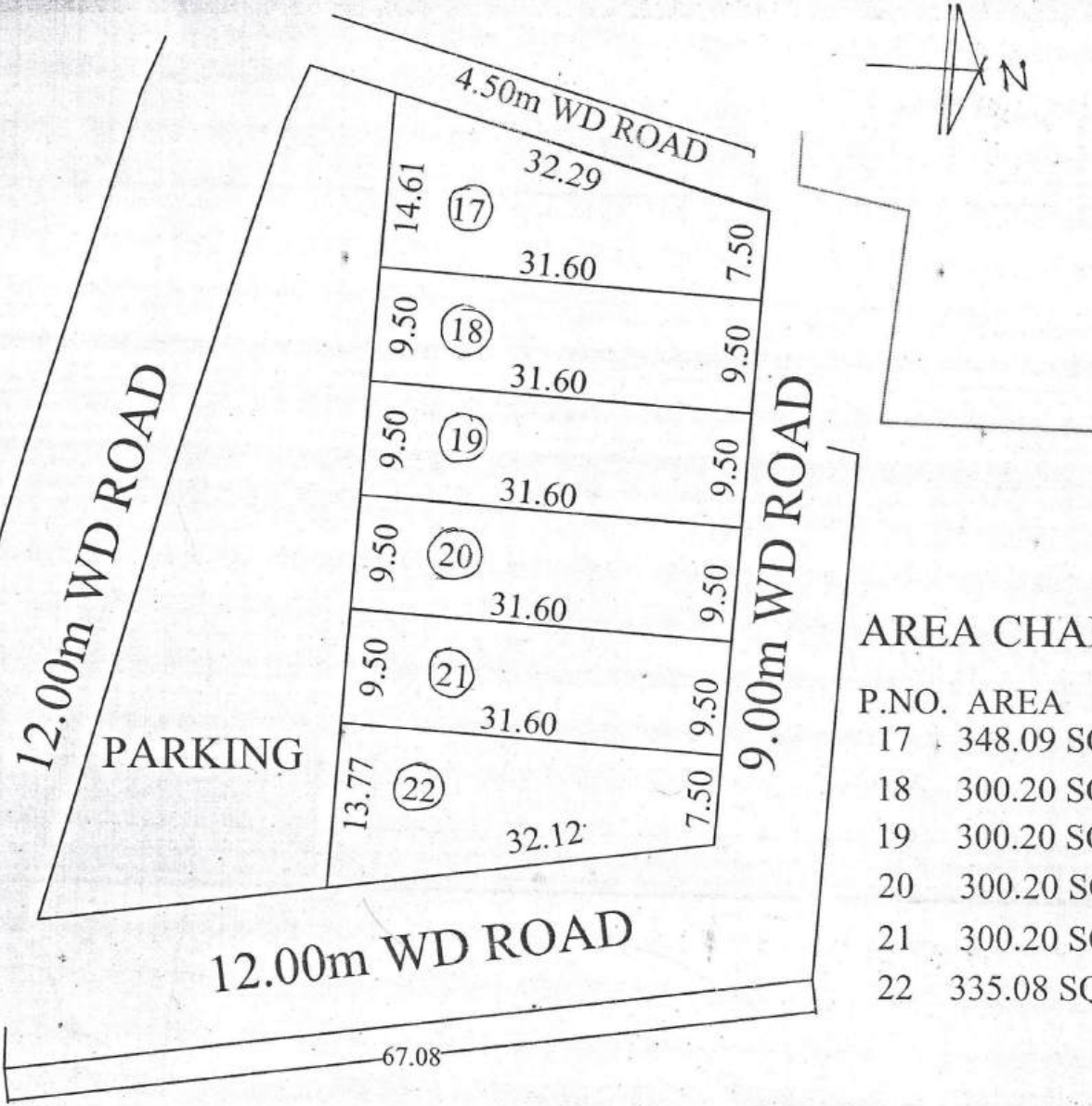

AREA CHART

P.NO.	AREA
17	348.09 SQM
18	300.20 SQM
19	300.20 SQM
20	300.20 SQM
21	300.20 SQM
22	335.08 SQM

*[Signature]*  
30/08/08  
PREPARED BY

*[Signature]*  
30/8/08  
sd. Zaksir Ali  
dt 26/08/08  
COMPARED BY J.E.

*[Signature]*  
sd. sharma  
dt 26/08/08  
A.E. A.T.P.

*[Signature]*  
30/08/08  
T.P.

SITE PLAN OF POLICE CHOWKI PLOT, COMMUNITY CENTER PLOT & HIGH SCHOOL PLOT - A  
POCKET-B MADHUBAN BAPUDHAM YOJNA , GDA, GZB.

HIGH SCHOOL PLOT - B/H.S.-1 = 1567.68 SQ.M.

COMM. CENTER PLOT - B/C.C.-1 = 2832.56 SQ.M.

POLICE CHOWKI PLOT - B/P.C.-1 = 3098.30 SQ.M.

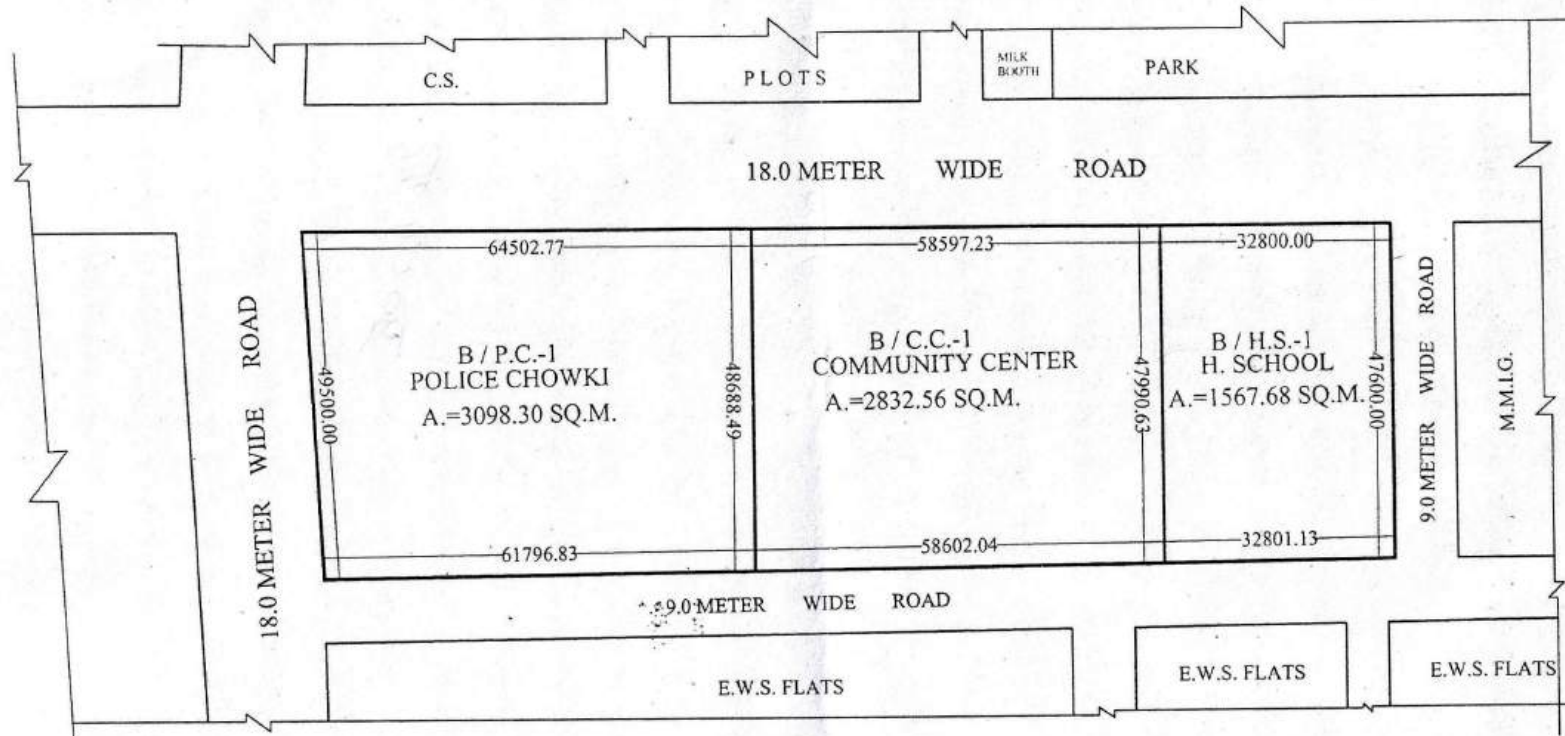

*Shrawi*  
11-02-21  
PREPARED BY.

*Shrawi*  
25/02/21  
COMPARED BY.

*[Signature]*  
MEAS.&AREA CAL.(J.E.)

*[Signature]*  
A.E.





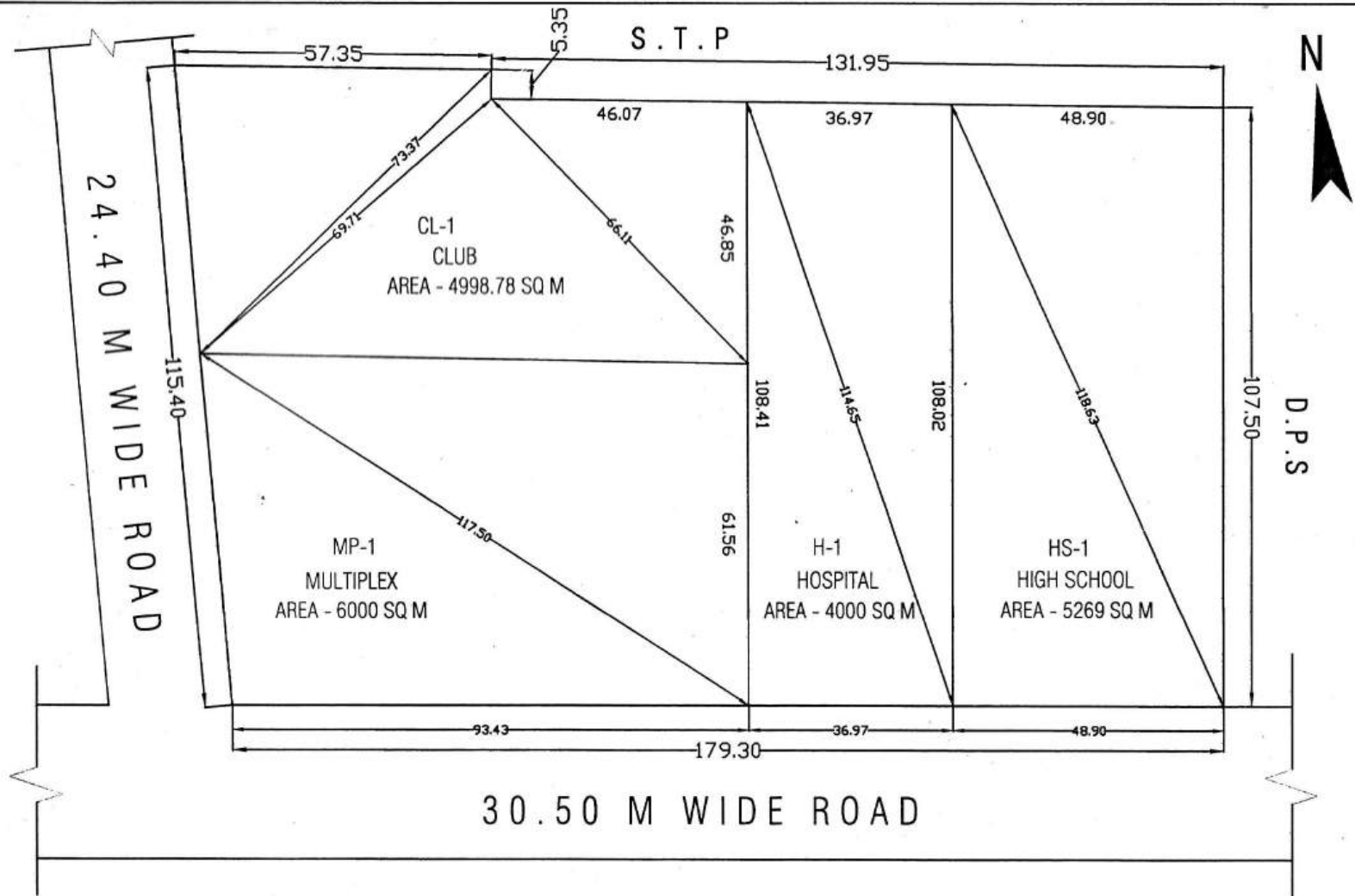

*[Signature]*  
E.E.

*[Signature]*  
TOWN PLANNER

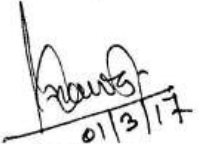
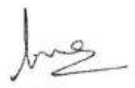
**REV. SITE PLAN OF MULTIPURPOSE COMMUNITY FACILITIES NEAR D.P.S., SK-IV, INDIRAPURAM**

**TOTAL AREA OF THE LAND - 20268.80 SQ.M**

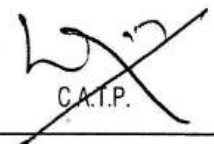

 01/3/17  
  
  
 2/13/17  
 03/2/17  
  
  

D/MAN      J.E.      A.E.      E.E.      T.P.      C.A.T.P.      SECRETARY      VICE CHAIRMAN

**SITE PLAN OF GROUP HOUSING PLOTS A/G.H.-2/1 TO A/G.H.-2/4 ON A/G.H.-2 PLOT AT POCKET ,  
MADHUBAN BAPUDHAM YOJNA , GDA, GZB.**

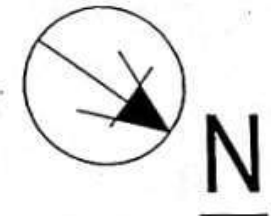
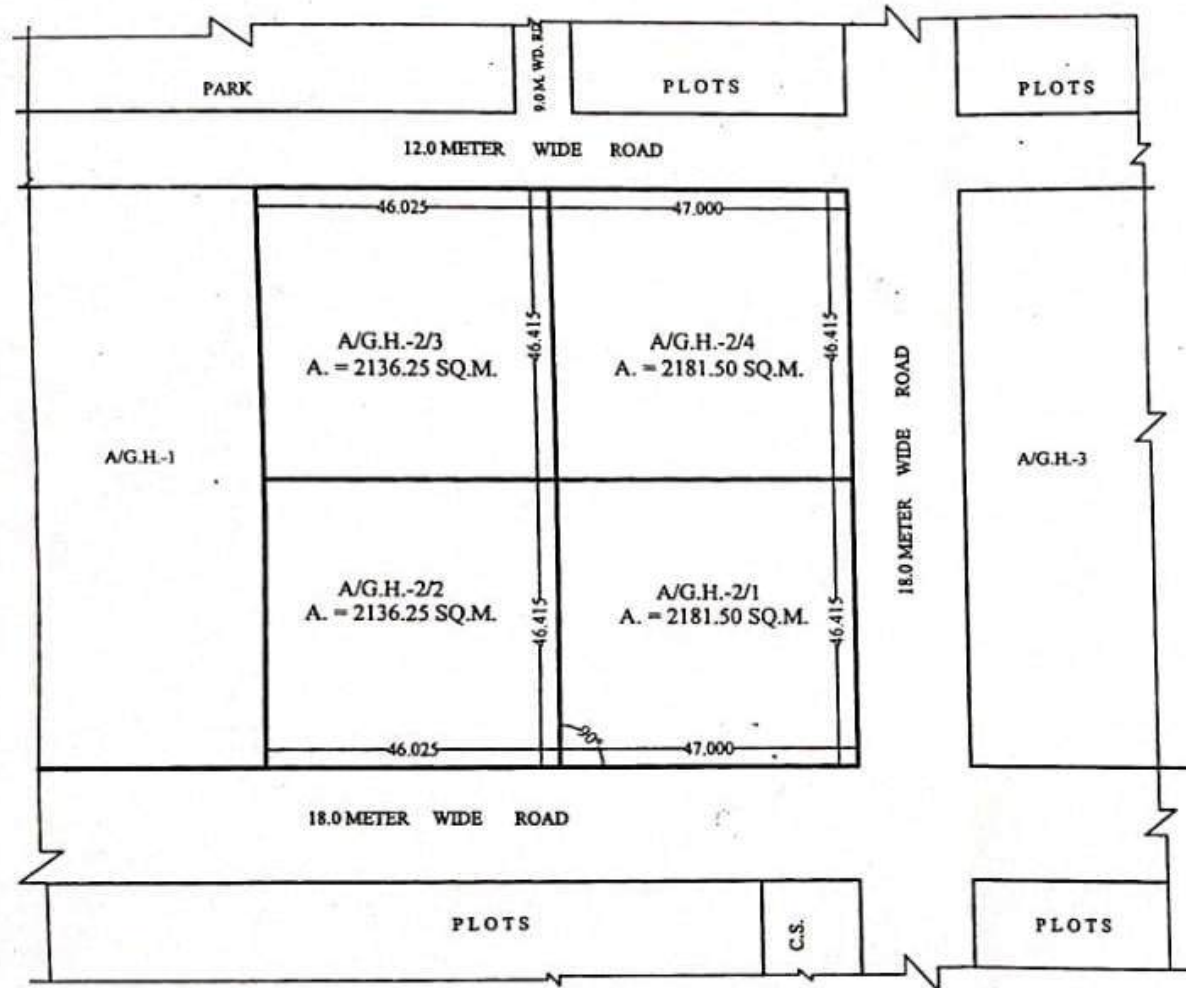

GR. COV. = 40%  
 F.A.R. = 2.5

A/G.H.-2/1 = 2181.50 SQ.M  
 A/G.H.-2/2 = 2136.25 SQ.M  
 A/G.H.-2/3 = 2136.25 SQ.M  
 A/G.H.-2/4 = 2181.50 SQ.M

-2-

*Shaw*  
 D/Man  
 -11-2020

AMIN

*[Signature]*  
 J.E.

*[Signature]*  
 A.E.

*[Signature]*  
 E.E.

*[Signature]*  
 OSD-LA

*[Signature]*  
 T.P.(R)

*[Signature]*  
 T.P.(K)

*[Signature]*  
 T.P.

*[Signature]*  
 SECRY.

*[Signature]*  
 V.C.

# REVISED PART LAYOUT PLAN OF COMMERCIAL PLOT C-1/1 TO C-1/16 & GROUP HOUSING PLOT GH-4 AT, KOYAL ENCLAVE SCHEME, LONI, G.D.A. GHAZIABAD

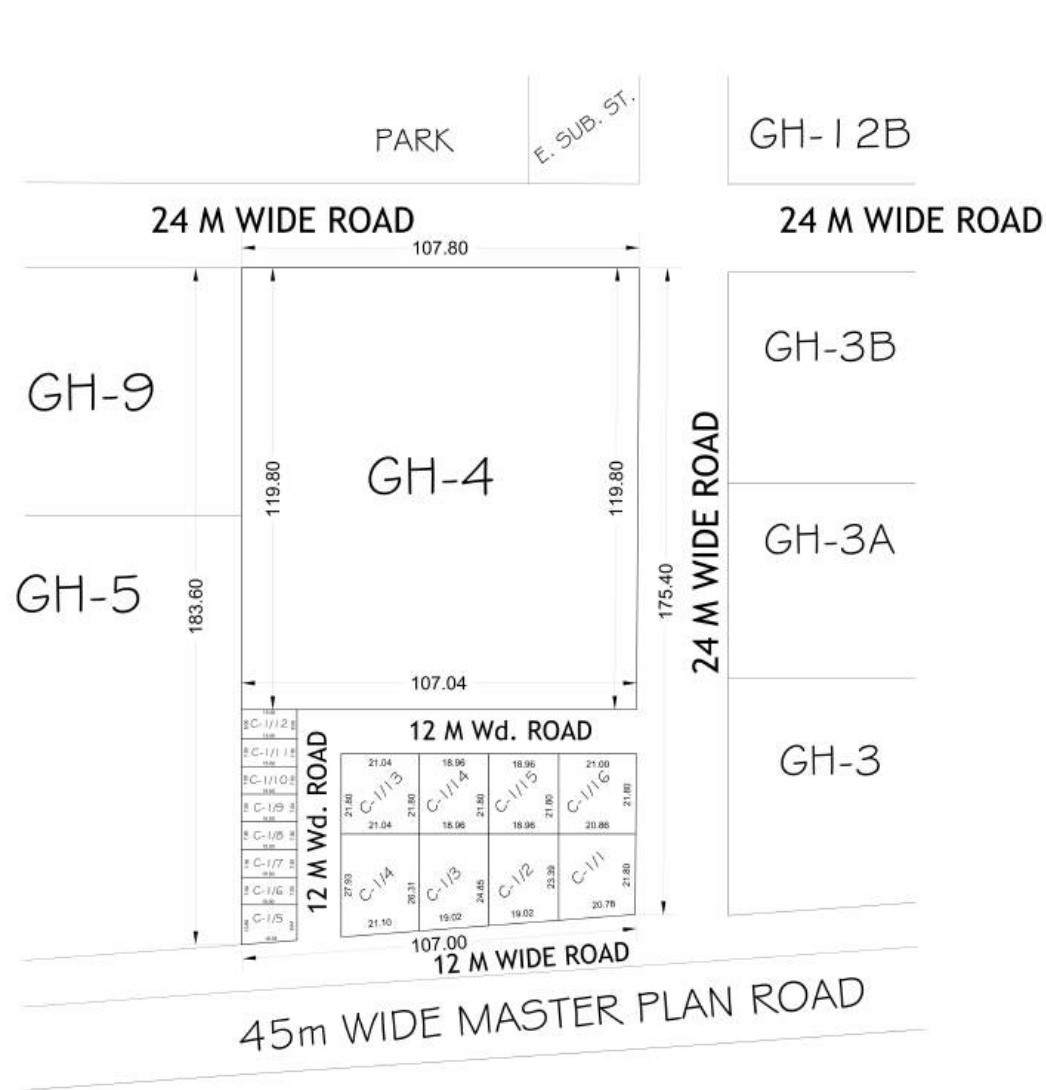

AREA SCHEDULE	
PLOT No.	AREA (IN Sqmt.)
C-1/1	469.78
C-1/2	457.36
C-1/3	485.00
C-1/4	570.61
C-1/5	153.40
C-1/6 to C-1/11	112.50
C-1/12	120.00
C-1/13	458.71
C-1/14 & C-1/15	413.32
C-1/16	456.29
<b>GH-04</b>	<b>12867.54</b>

COMMERCIAL SET BACK	
BELOW 200.00 Sqmt.	ABOVE 200.00 Sqmt.
FRONT - 3.00 Sqmt.	FRONT - 4.50 Sqmt.
REAR - 3.00 Sqmt.	REAR - 3.00 Sqmt.
	SIDE - 3.00 Sqmt.
	SIDE - 3.00 Sqmt.



# GHAZIABAD DEVELOPMENT AUTHORITY

## REVISED PART LAYOUT PLAN OF GROUP HOUSING PLOT No. - GH 5 & 6, AT KOYAL ENCLAVE SCHEME, LONI, GHAZIABAD

### AREA SCHEDULE

GROUP HOUSING PLOT GH - 5, 6 = 24143.46 Sqmt.

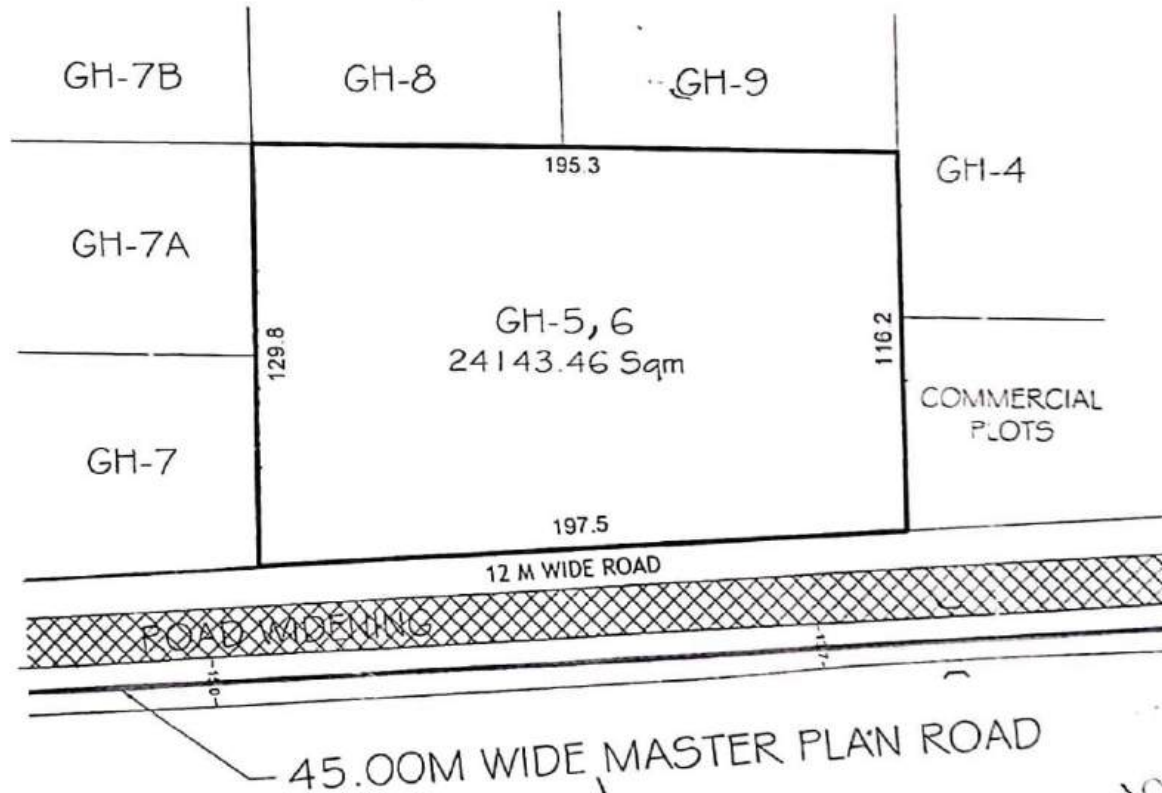

1/2022

AMIN

JUNIOR ENGINEER

ASSISTANT ENGINEER

EXECUTIVE ENGINEER

TOWN PLANNER

C.A.T.P

SECRETARY

VICE CHAIRMAN

REV. PART LAYOUT PLAN OF COMM. PLOTS & SHOPS ON C.P.-1 AT GYAN KHAND - III  
 INDIRAPURAM, G.D.A. GHAZIABAD:-

AL PLOT AREA : 3533.00 SQ.M.

GR. COV. = 60%  
 F.A.R. = 1.5

TYPE AREA (APROX.) NOS.

COMMERCIAL PLOT - 1	= 325.20 SQ.M.	= 01
COMMERCIAL PLOT - 2	= 314.45 SQ.M.	= 01
SHOPS - 6.70M. X 12.50M.	= 83.75 SQ.M.	= 06
SHOPS - 6.00M. X 09.50M.	= 57.00 SQ.M.	= 07
SHOPS - 5.00M. X 07.47M.	= 37.35 SQ.M.	= 05



AN AMIN J.E. A.E. E.E. TEH.SA. T.P. G.A.T.P. SECRETARY VICE CHAIRMAN

# PROPOSED SITE PLAN FOR HEALTHCARE HUB AND MUSICAL FOUNTAIN & MULTI MEDIA SHOW POCKET-E MADHUBAN BAPUDHAM YOJNA; GZB.

HEALTH CARE HUB AREA - 30484.50 SQ.M.

MUSICAL FOUNTAIN AND MULTIMEDIA SHOW AREA - 3000.00 SQ.M.

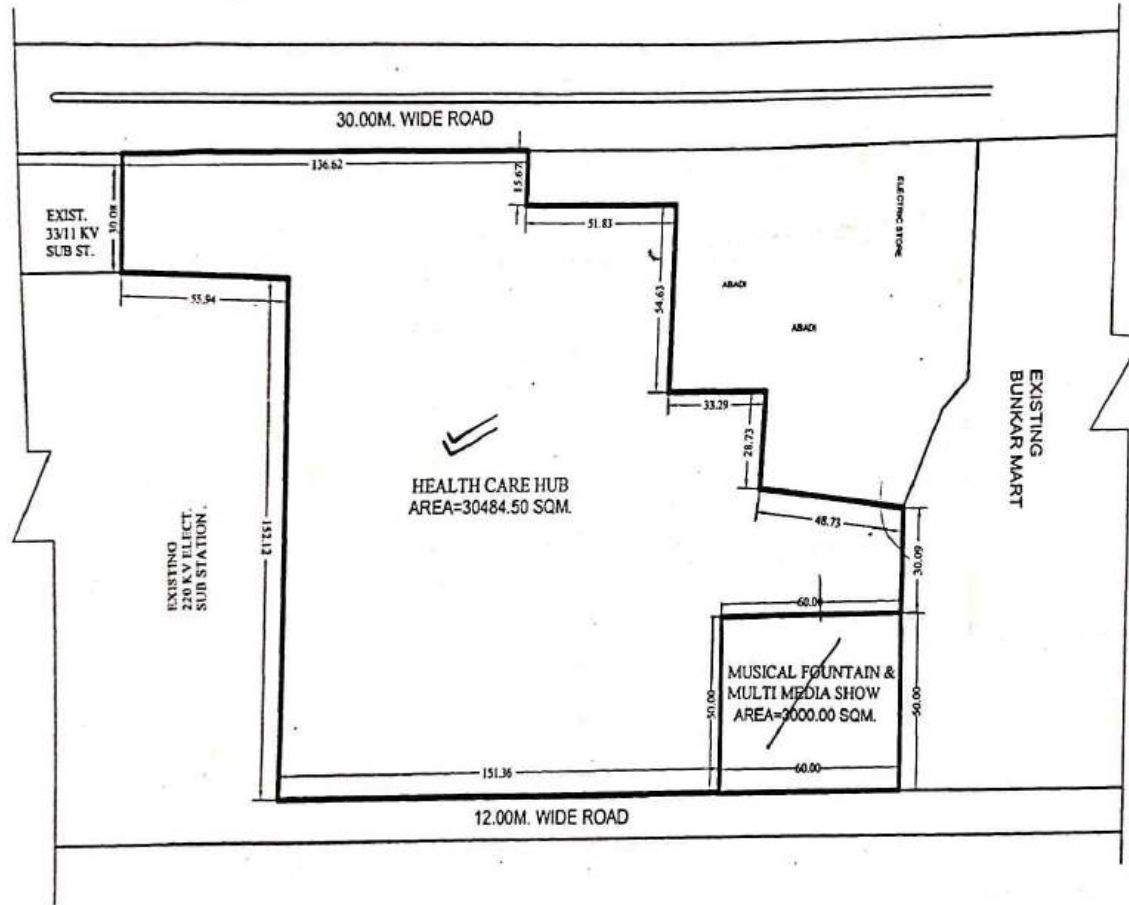

*Amir*  
16-11-19  
D/Man AMIN

*Sudh*  
19-11-19  
J.E.

*Bh*  
A.E. E.E.

*Su*  
DSD/G-2-31  
VERMA

*P*  
T.P.(R)

*P*  
T.B.(K)





*[Signature]*  
SECRETARY

*Keerthi*  
VICE CHAIRMAN

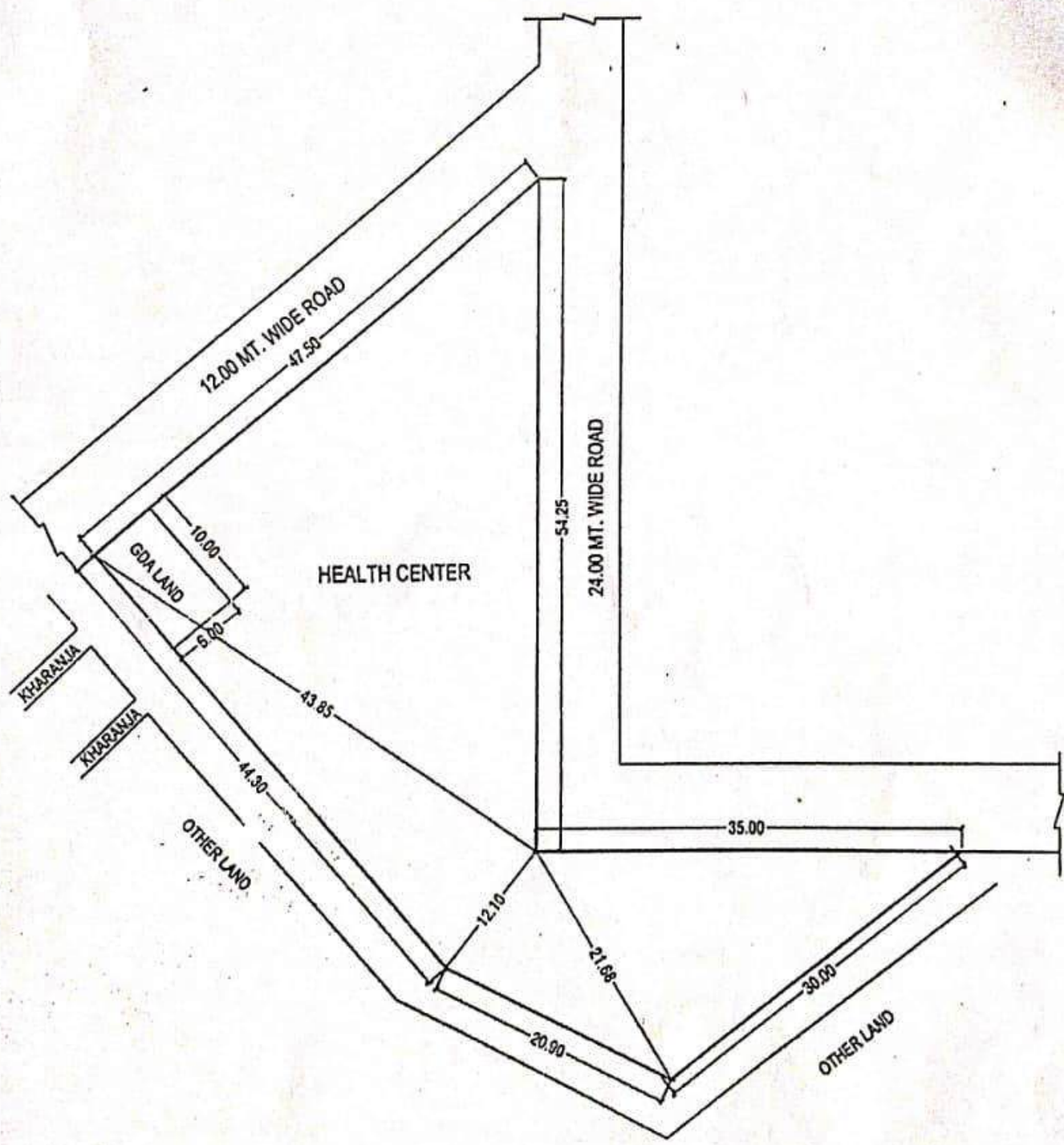
# SITE PLAN OF HEALTH CENTER IN KOYAL ENCLAVE SCHEME AT (3) SCHEME AT GHAZIABAD

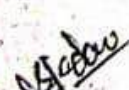
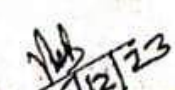
AREA OF HEALTH CENTER = 1642.38 SQ.M.  
 AREA OF GDA LAND = 60 SQ.M.

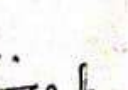

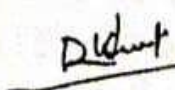
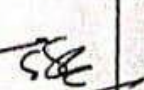
 D/M  
 I.E.  
 A.E. 15/12/23  
 E.E.-8  
 T.P.  
 C.A.T.P.  
 SECY.  
 V.C.

लवकेश कुमार  
 विशारती अभियन्ता

# REVISED PART LAYOUT PLAN OF COMMERCIAL LAND IN INDRAPRASTH YOZNA, POCKET - H, LONI, GZB.

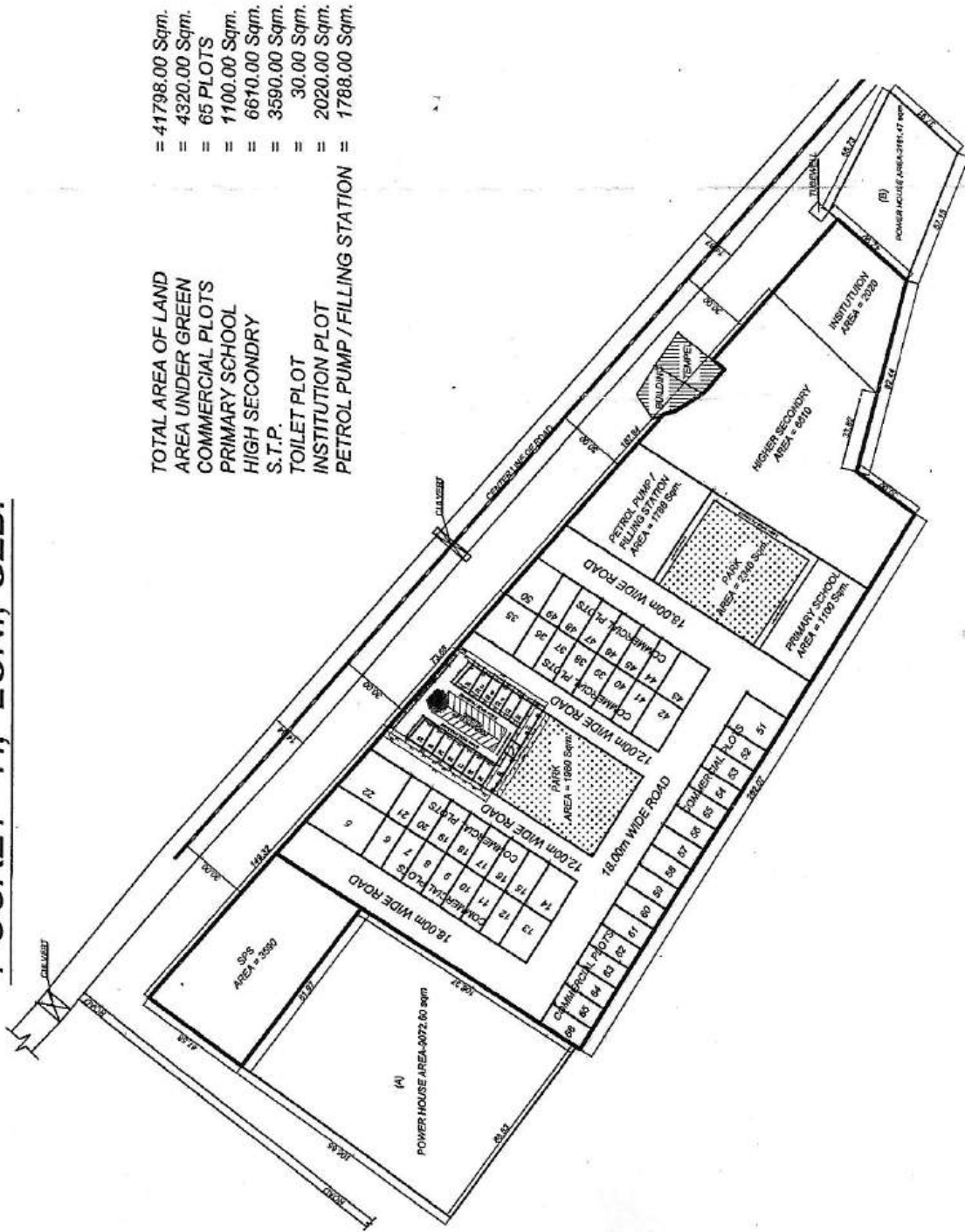

- = 41798.00 Sqm.
- = 4320.00 Sqm.
- = 65 PLOTS
- = 1100.00 Sqm.
- = 6670.00 Sqm.
- = 3590.00 Sqm.
- = 30.00 Sqm.
- = 2020.00 Sqm.
- = 1788.00 Sqm.

TOTAL AREA OF LAND  
 AREA UNDER GREEN  
 COMMERCIAL PLOTS  
 PRIMARY SCHOOL  
 HIGH SECONDARY  
 S.T.P.  
 TOILET PLOT  
 INSTITUTION PLOT  
 PETROL PUMP / FILLING STATION

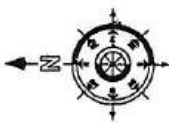

AREA SCHEDULE (COMM. PLOTS)  
 PLOT Nos. - AREA (IN Sqm.)

PLOT Nos.	AREA (IN Sqm.)
5	510.00
6 To 12	105.00
13 & 14	270.00
15 To 21	195.00
22	445.00
23	64.05
24 To 29	55.00
30 & 31	85.00
32 & 33	55.00
33A, 33B & 33C	55.00
34	65.20
35	360.00
36 To 41	195.00
42 & 43	270.00
44 To 49	195.00
50	202.00
51	314.00
52 To 66	195.00

D/Man Jun. Engr. Astd. Engr. Ex. Engr. T.P.(R) T.P.(K) C.A.T.P. SECRETARY V.C.



S.T.P.

SHAMSHAN

PARK / GREEN

AREA=5983.25 SQMT.

BLOCK-B

PARK/GREEN

AREA=2413.30 SQMT.

BASEMENT LINE

18.00 M. WIDE ROAD

WORLD RESIDENCY

45.00m WIDE ROAD

GREEN BELT

ROAD

CANAL



REVISED PLOTTED DEVELOPMENT  
PLAN (PART LAYOUT) ON PREVIOUS  
G.H. 06.G.H. - 07 & G.H. - 08  
INDIRAPURAM EXT. GHAZIABAD

(1) TOTAL AREA OF LAND	= 30359.51 SQMT. (100.00%)
(2) AREA UNDER RESIDENTIAL	= 15977.78 SQMT. ( 52.65%)
(3) AREA UNDER GARBEDE COLECTIO	= 47.00 SQMT. ( 0.15%)
(4) AREA UNDER GREEN	= 8376.55 SQMT. ( 27.59%)
(5) AREA UNDER COMMERCIAL	= 1500.00 SQMT. ( 4.94%)
(6) AREA UNDER ROAD	= 4458.18 SQMT. ( 14.69%)

A BLOCK AREA CHART

S.NO	PLOT NO	AREA IN SQMT.	F.S.B	R.S.B	S.S.B
01	01	=335.00	3.0	3.0	3.0
02	02-03	=310.00	3.0	3.0	3.0
03	04-05	=335.00	3.0	3.0	3.0
04	06-11	=310.00	3.0	3.0	3.0
05	12-13	=335.00	3.0	3.0	3.0
06	14-19	=335.00	3.0	3.0	3.0
07	20	=335.00	3.0	3.0	3.0
08	21	=342.70	3.0	3.0	3.0
09	22	=422.72	3.0	3.0	3.0
10	23	=410.31	3.0	3.0	3.0
11	24	=348.56	3.0	3.0	3.0
12	25	=362.18	3.0	3.0	3.0
13	26	=362.18	3.0	3.0	3.0
14	27	=389.41	3.0	3.0	3.0
15	28	=403.03	3.0	3.0	3.0
16	29	=416.65	3.0	3.0	3.0
17	30	=430.26	3.0	3.0	3.0
18	31	=443.88	3.0	3.0	3.0
19	32	=578.75	3.0	3.0	3.0

B - BLOCK AREA CHART

20	01	=306.00	3.0	3.0	3.0
21	02-06	=310.00	3.0	3.0	3.0
22	07	=335.00	3.0	3.0	3.0
23	08-09	=310.00	3.0	3.0	3.0
24	10	=362.36	3.0	3.0	3.0
25	11	=272.04	3.0	3.0	3.0
26	12	=336.72	3.0	3.0	3.0
27	13	=346.40	3.0	3.0	3.0
28	14	=310.00	3.0	3.0	3.0
29	15	=335.00	3.0	3.0	3.0

A- BLOCK AREA CHART (COMMERCIAL PLOTS)

S.NO	PLOT NO	AREA IN SQMT.	F.S.B	R.S.B	S.S.B
01	01-02	=620.00	3.0	3.0	3.0

B- BLOCK AREA CHART (COMMERCIAL PLOTS)

S.NO	PLOT NO	AREA IN SQMT.	F.S.B	R.S.B	S.S.B
01	03	=260.00	3.0	3.0	3.0

D/MAN

AMIN

J.E.

A.E.

E.E.

TEH.

T.P/C.T.P

SECY.

V.C

# REV. PART LAYOUT PLAN OF COMMERCIAL PLOTS (VEHICLE FREE) AT NYAY KHAND- 1 INDIRAPURAM GZB.

## AREA-CHART

CP - 1	= 173.72 Sqmt.
CP - 2	= 173.72 Sqmt.
CP - 3	= 150.00 Sqmt.
CP - 4 TO CP-8	= 135.00 Sqmt.
CP - 9	= 154.43 Sqmt.
CP-10	= 157.53 Sqmt.
CP-11 TO CP-15	= 135.00 Sqmt.
CP-16	= 150.00 Sqmt.
CP-17 TO CP-23	= 135.00 Sqmt.
CP-24	= 150.25 Sqmt.
CP-25	= 141.67 Sqmt.
CP-26	= 132.66 Sqmt.
CP-27	= 128.95 Sqmt.
CP-28	= 133.40 Sqmt.
PARKING	= 1758.09 Sqmt.
PETROL PUMP	= 657.58 Sqmt.

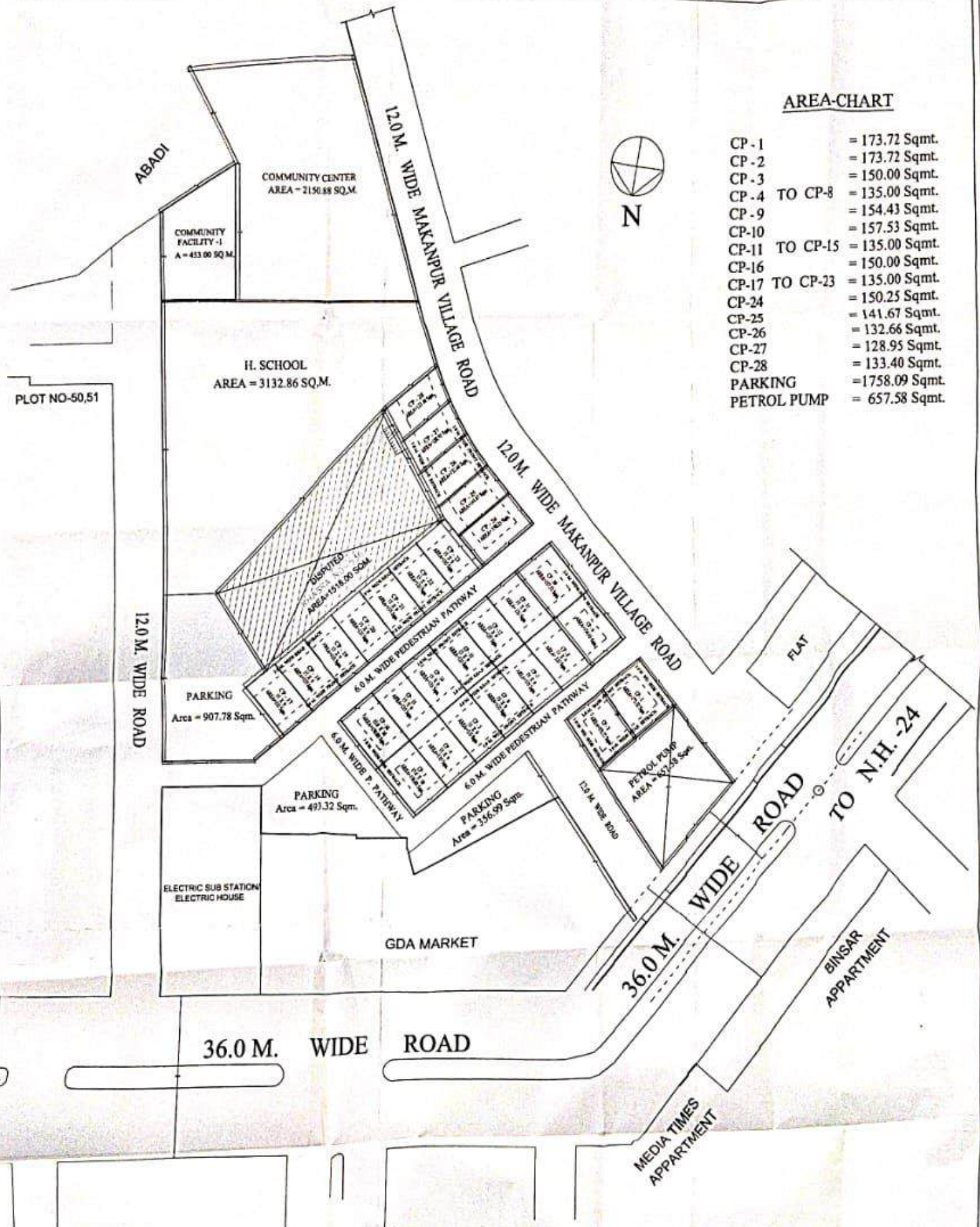

 D/MAN  
 AMIN  
 J.E.  
 A.E.  
 E.E.  
 T.H.SILDAR/ INCHARGE LAND ACQUISITION  
 T.P.  
 CATP/AS  
 SECRETARY  
 VICE

SITE PLAN OF PLOT FOR BANK, ART GALLERY, HOTEL & FILLING STATION AT KARPOORI PURAM SCHEME.

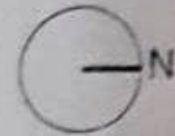

- AREA OF ART GALLERY = 540 SQM
- AREA OF BANK = 580.00 SQM
- AREA OF HOTEL = 1007.00 SQM
- AREA OF FILLING STATION = 533.00 SQM

PREPARED BY. *[Signature]* AMIN    MEASURED BY. *[Signature]* J.E.    A.E.    E.E. *[Signature]*    TEH.(L.A.)    T.P. *[Signature]*    C.A.T.P.    SECY. *[Signature]*



# NUMBERING PLAN OF GDA HOUSE'S IN KARPURI PURAM, GHAZIABAD



LEGENDS			
S.No. -	BLOCK / HOUSE No.	AREA	- Nos.
1.	KA-1 to KA-30	- 90.00 Sqmt.	- 30
	KA-33 to KA-62	- 90.00 Sqmt.	- 30
	KA-65 to KA-72	- 112.50 Sqmt.	- 08
	KA-73 to KA-92	- 90.00 Sqmt.	- 20
	KA-95 to KA-114	- 90.00 Sqmt.	- 20
	KA-115 to KA-160	- 112.50 Sqmt.	- 46
2.	KB-1 to KB-44	- 152.00 Sqmt.	- 44
3.	KB-45 to KB-105	- 120.00 Sqmt.	- 61
4.	KB-106 to KB-121	- 105.00 Sqmt.	- 16
5.	KB-122 to KB-134	- 120.00 Sqmt.	- 13
6.	KB-135 to KB-138	- 90.00 Sqmt.	- 04
	<b>TOTAL</b>		<b>- 292</b>

PLOT No. - KA, KA, KA & KA  
- 31, 32, 53 & 54

MISSING No. - KA & KA

PREPARED BY  
09/10/2020

Jun. ENGR.

Asst. ENGR.

S. ENGR.

T.P.(R)

T.P. (K)

C.A.T.P.

SECRETARY

VICE CHAIRMAN

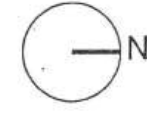

SITE PLAN OF PLOT FOR OLD AGE HOME AT KARPOORI PURAM

46

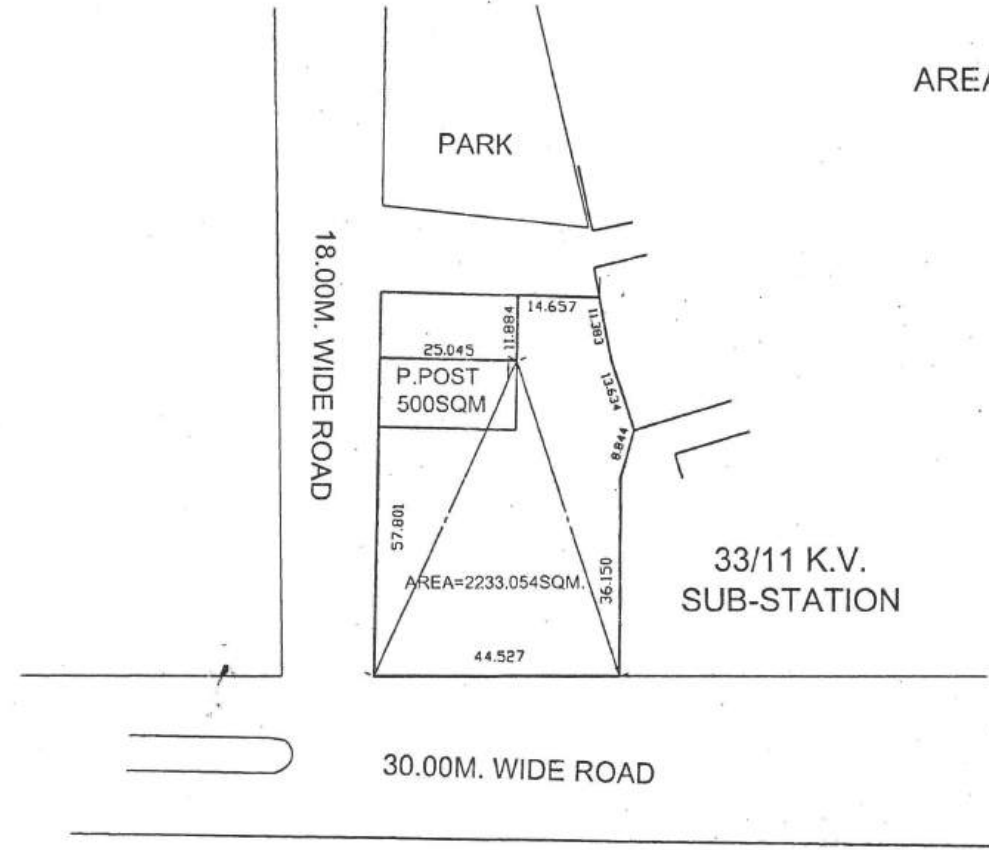

AREA OF PLOT = 2233.05 SQM

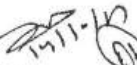

PREPARED BY.  AMIN  
MEASURED BY.  J.E.  A.E.  E.E.  T.E. (L.A.)  T.P.  C.A.T.P.  SECY.  V.C.

# SITE PLAN OF RESIDENTIAL PLOT No. - K-1, GROUP HOUSING (GH) No. - 1, 1A & 10, PRIMARY / NURSURY (P/N) No. - 1 & FILLING STATION AT KOYAL ENCLAVE SCHEME, LONI, GHAZIABAD

## AREA SCHEDULE

RESIDENTIAL PLOT No.K-1	= 1265.00 Sqm.
FILLING STATION	= 2500.00 Sqm.
GROUP HOUSING (G.H.) No.-1	= 8565.00 Sqm.
GROUP HOUSING (G.H.) No.-1A	= 6958.00 Sqm.
GROUP HOUSING (G.H.) No.-10	= 7140.00 Sqm.
PRIMARY / NURSURY (P/N) No.-1	= 3726.00 Sqm.

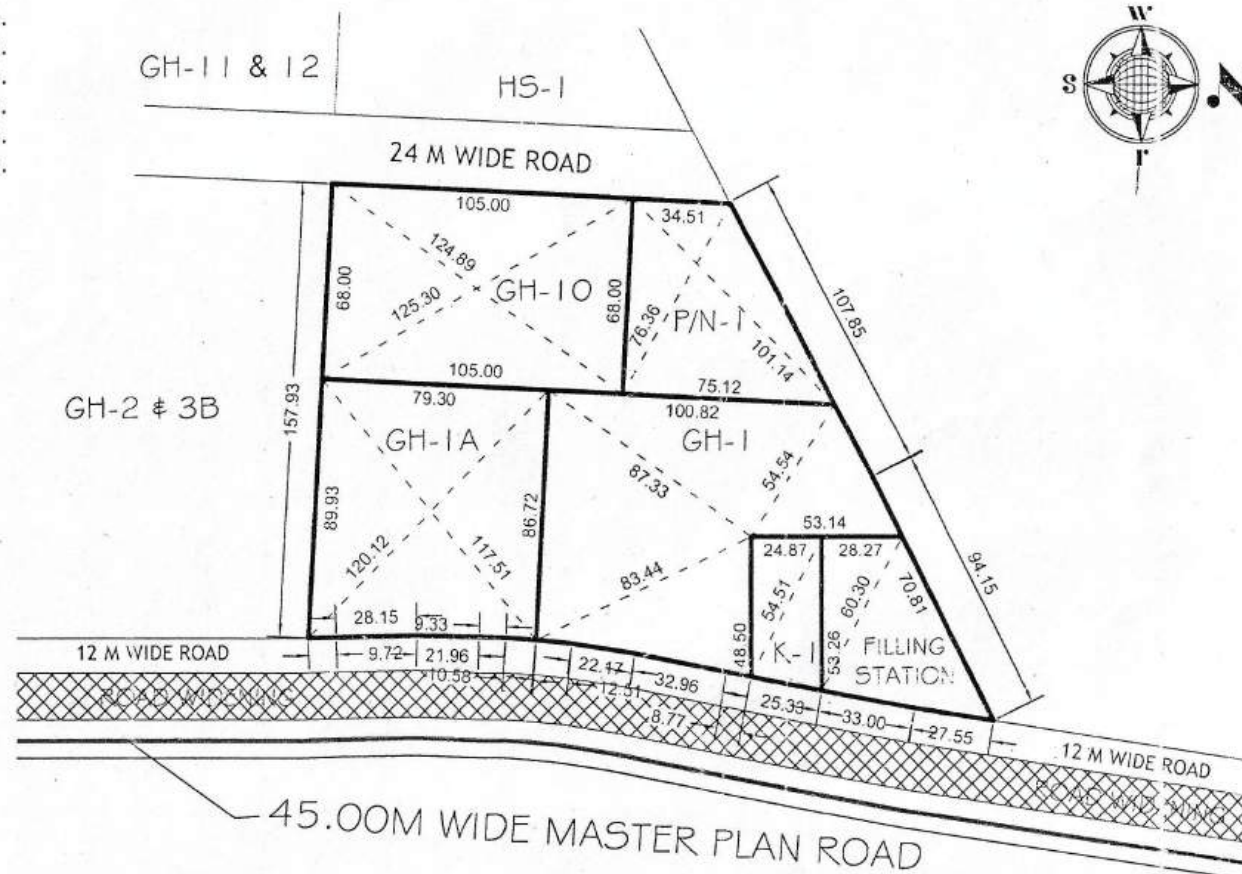

*[Signature]*  
NITIN KUMAR  
D/Man

*[Signature]*  
ANAND SWAIN  
AMIN

*[Signature]*  
R.K. KAUSHIK  
JUNIOR ENGINEER

*[Signature]*  
NARENDRA KUMAR  
ASSISTANT ENGINEER

*[Signature]*  
R.K. JAISWAL  
EXECUTIVE ENGINEER

*[Signature]*  
RAJKUMAR MITTAL  
TEHSILDAR (L.A.)

*[Signature]*  
JYOT PRASAD  
TOWN PLANNER

*[Signature]*  
ISTYAD AHMED  
C.A.T.S.

*[Signature]*  
RAVINORA GODSOLE  
SECRETARY

*[Signature]*  
VIJAY KUMAR GOYAL  
VICE CHAIRMAN

# PLAN OF GROUP HOUSING (GH) No. - 3, 3A & 3B AT KOYAL ENCLAVE SCHEME, LONI, GHAZIABAD

## AREA SCHEDULE

GROUP HOUSING (G.H.) No.-3	= 5994.08 Sqm.
GROUP HOUSING (G.H.) No.-3A	= 5268.84 Sqm.
GROUP HOUSING (G.H.) No.-3B	= 5766.84 Sqm.

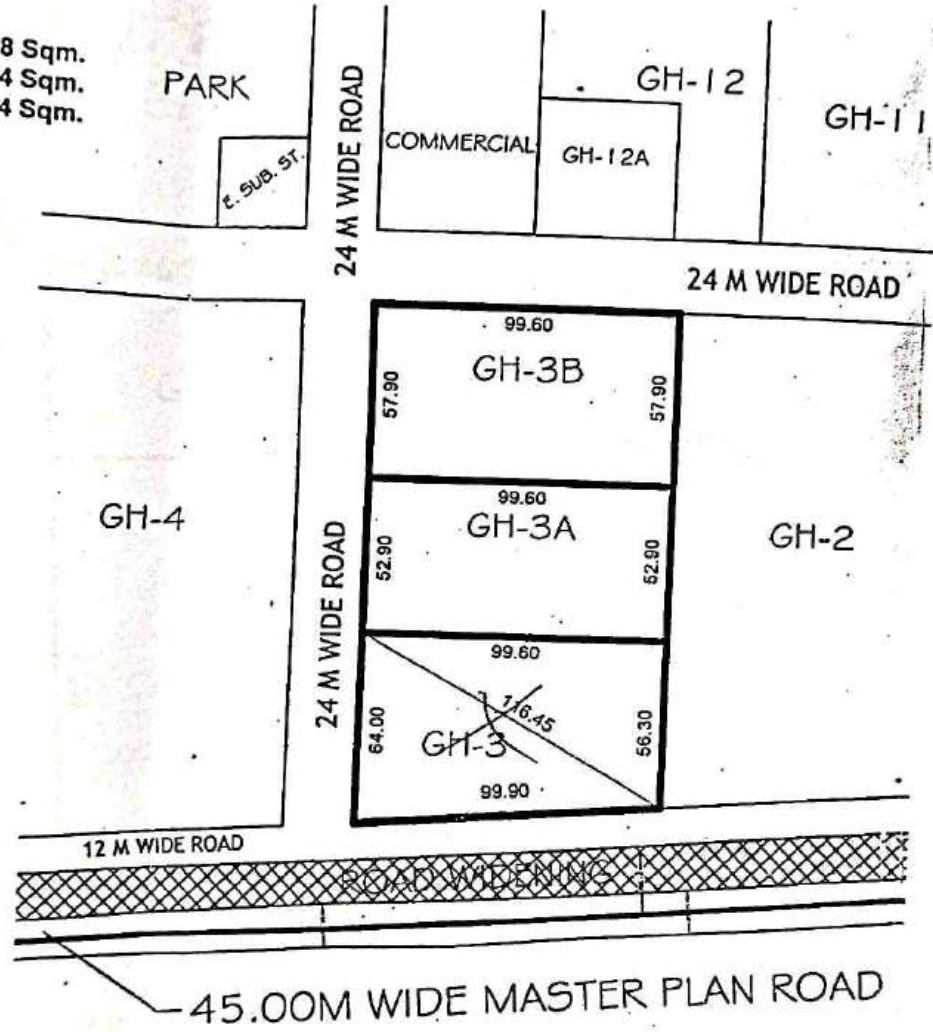

PRODUCED BY AN AUTODESK EDUCATIONAL PRODUCT

*[Signature]*  
13/02/14  
KUMAR  
MAN

*[Signature]*  
R.K. KAUSHIK  
JUNIOR ENGINEER

*[Signature]*  
KAPTAN BINGH  
EXECUTIVE ENGINEER

*[Signature]*  
R.K. JAISWAL  
EXECUTIVE ENGINEER

*[Signature]*  
JYOTI PRASAD  
TOWN PLANNER

*[Signature]*  
S.C. SAUR  
C.A.T.P.

*[Signature]*  
RAVINDRA GODSOLE  
SECRETARY

*[Signature]*  
SANJAY KUMAR YADAV  
VICE CHAIRMAN

2000 मी. से अधिक की सूची में सम्मिलित - 6

PRODUCED BY AN AUTODESK EDUCATIONAL PRODUCT

# REVISED SITE PLAN OF HS-2 AT KOYAL ENCLAVE SCHEME, LONI, GHAZIABAD

## AREA SCHEDULE

HIGHER SECONDRY-2 (H/S-2) = 6395.00 Sqmt.  
 GROUND COVERAGE = 30 %  
 PERMISSIBLE F.A.R. = 1.00



[Signature]      [Signature] 27/11/2020      [Signature] 27.11.20      [Signature]      [Signature]      [Signature]      [Signature]      [Signature]      [Signature]

IAN      JUN. ENGR.      ASTT. ENGR.      S. ENGR.      T. P. (R)      T. P. (K)      [Signature]      SECRETARY      VICE CHAIRMAN

# SITE PLAN OF RESIDENTIAL PLOT No. - K-1, GROUP HOUSING (GH) No. - 1, 1A & 10, PRIMARY / NURSURY (P/N) No. - 1 & FILLING STATION AT KOYAL ENCLAVE SCHEME, LONI, GHAZIABAD

## AREA SCHEDULE

RESIDENTIAL PLOT No.K-1	= 1265.00 Sqm.
FILLING STATION	= 2500.00 Sqm.
GROUP HOUSING (G.H.) No.-1	= 8565.00 Sqm.
GROUP HOUSING (G.H.) No.-1A	= 6958.00 Sqm.
GROUP HOUSING (G.H.) No.-10	= 7140.00 Sqm.
PRIMARY / NURSURY (P/N) No.-1	= 3726.00 Sqm.

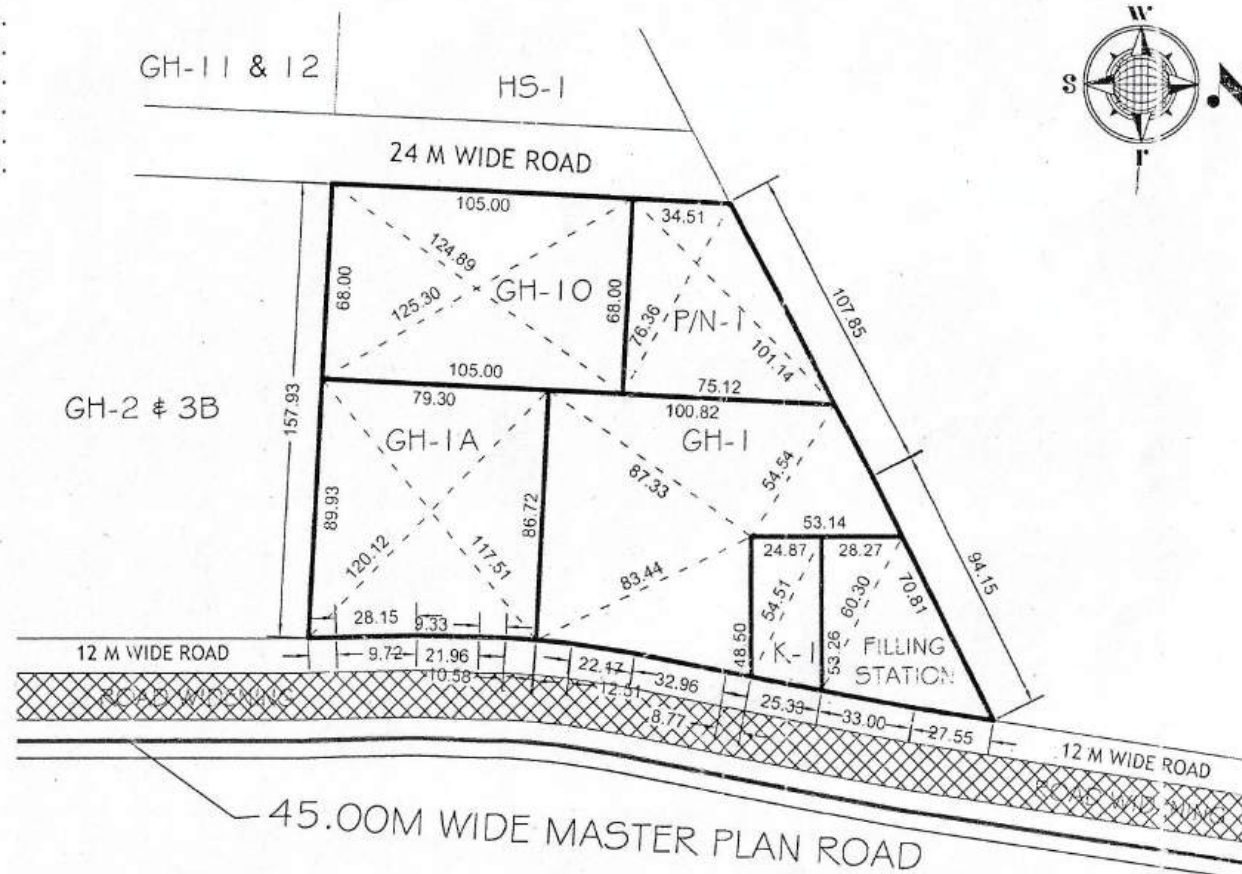

*[Signature]*  
NITIN KUMAR  
D/Man

*[Signature]*  
ANAND SWAMI  
AMIN

*[Signature]*  
R.K. KAUSHIK  
JUNIOR ENGINEER

*[Signature]*  
NAKENDRA KUMAR  
ASSISTANT ENGINEER

*[Signature]*  
R.K. JAISWAL  
EXECUTIVE ENGINEER

*[Signature]*  
RAJKUMAR MITTAL  
TEHSILDAR (L.A.)

*[Signature]*  
JYOT PRASAD  
TOWN PLANNER

*[Signature]*  
ISTYAD AHMED  
C.A.T.S.

*[Signature]*  
RAVINORA GODSOLE  
SECRETARY









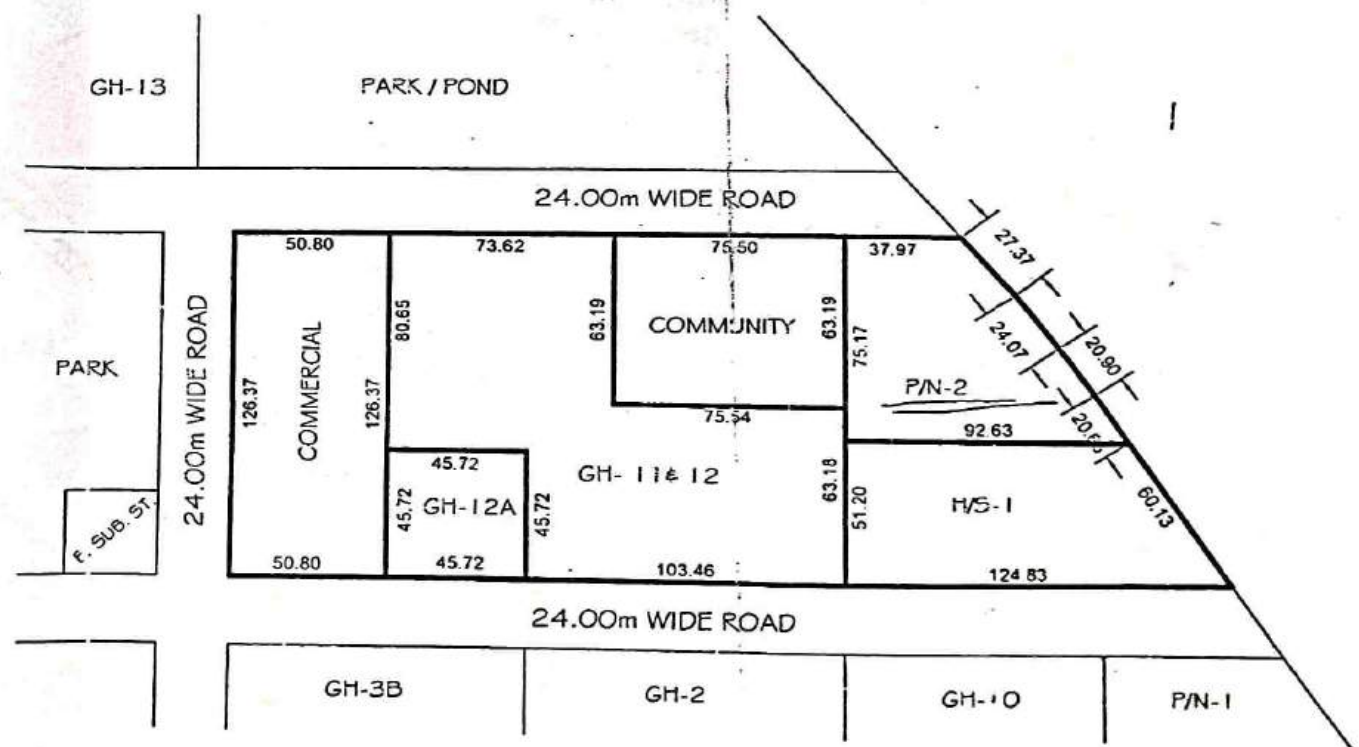

*[Signature]*  
VIJAY KUMAR GOYAL  
VICE CHAIRMAN

# PLAN OF COMMERCIAL PLOT, GROUP HOUSING (GH) No. - 11 & 12, 12A, PRIMARY / NURSURY (P/N) No. - 2, HIGHER SECONDRY (H.S.) -1, COMMUNITY AT KOYAL ENCLAVE SCHEME, LONI, GHAZIABAD

## AREA SCHEDULE

COMMERCIAL PLOT	= 6417.02 Sqm.
GROUP HOUSING (G.H.) No.-12A	= 2090.00 Sqm.
GROUP HOUSING (G.H.) No.-11 & 12	= 11915.26 Sqm.
COMMUNITY	= 4772.00 Sqm.
PRIMARY / NURSURY (P/N) No.-2	= 5011.00 Sqm.
HIGHER SECONDRY (H/S) No.-1	= 5547.00 Sqm.



 21/06/16  
 NITIN KUMAR  
 D/Man  
  
 ANAND SHARMA  
 TANNIN  
  
 R.K. KAUSHIK  
 JUNIOR ENGINEER  
  
 KAREMENDRA MISHRA  
 ASSISTANT ENGINEER  
  
 R. JAISWAL  
 EXECUTIVE ENGINEER  
  
 RAJKUMAR MITTAL  
 TEHSILDAR (L.A.)  
  
 23/6/16  
 JYOTI PRASAD  
 TOWN PLANNER  
  
 23/6/16  
 ISTIYAQ AHMED  
 C.A.P.  
  
 24/6/16  
 RAVINDRA GODBOLE  
 SECRETARY  
  
 V.J. KUMAR GOVAL  
 VICE CHAIRMAN

**REVISED PART LAYOUT PLAN OF GROUP HOUSING PLOT OF GH-12B, GH-12C & GH-12D AT KOYAL ENCLAVE SCHEME, LONI, G.D.A. GHAZIABAD.**

GROUND COVERAGE - 40%  
F.A.R. - 25

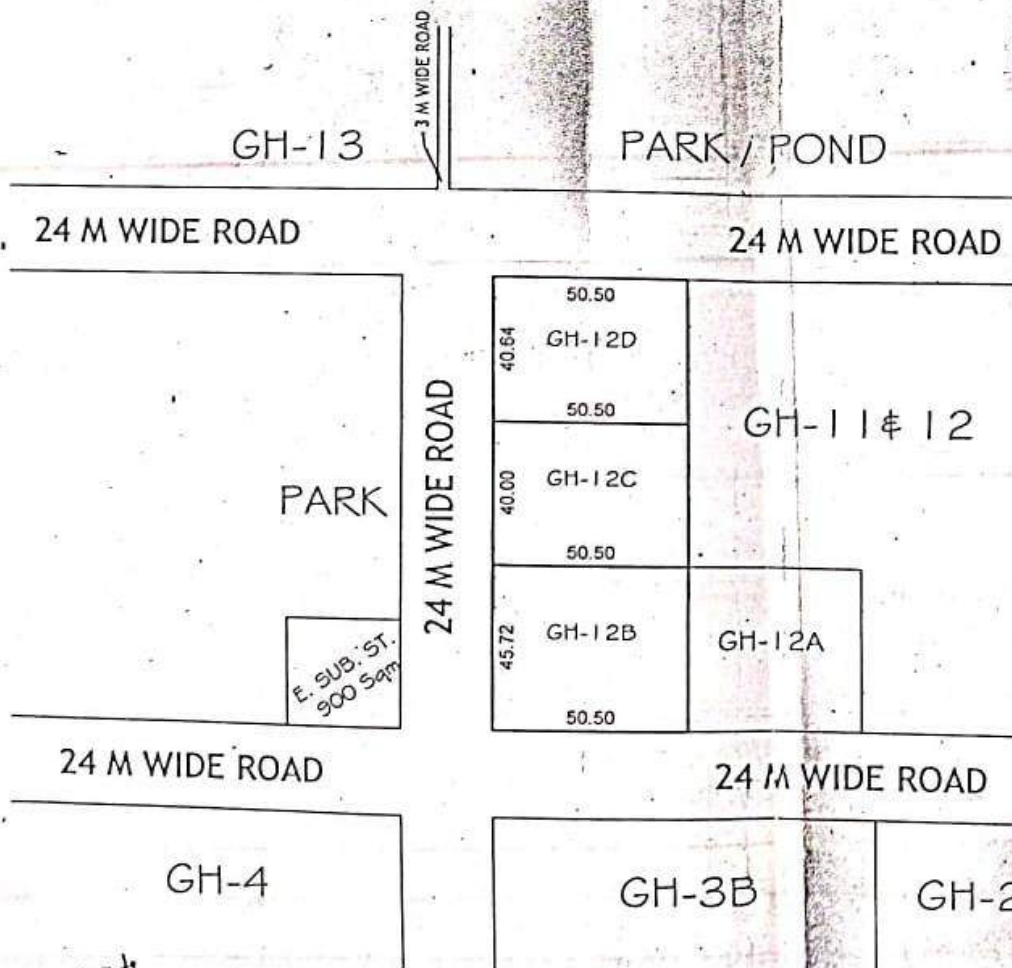

AREA SCHEDULE	
PLOT No.	AREA (In Sqmt.)
GH-12B	2308.86
GH-12C	2020.00
GH-12D	2052.32

*[Signature]*  
26/08/2020  
D/MAN

For measurements only.  
*[Signature]*  
27/8/2020  
JUNIOR ENGINEER

*[Signature]*  
ASSISTANT ENGINEER

*[Signature]*  
SUPERINTENDENT ENGINEER

*[Signature]*  
TOWN PLANNER (R)

*[Signature]*  
TOWN PLANNER (K)

*[Signature]*  
SECRETARY

*[Signature]*  
VICE CHAIRMAN



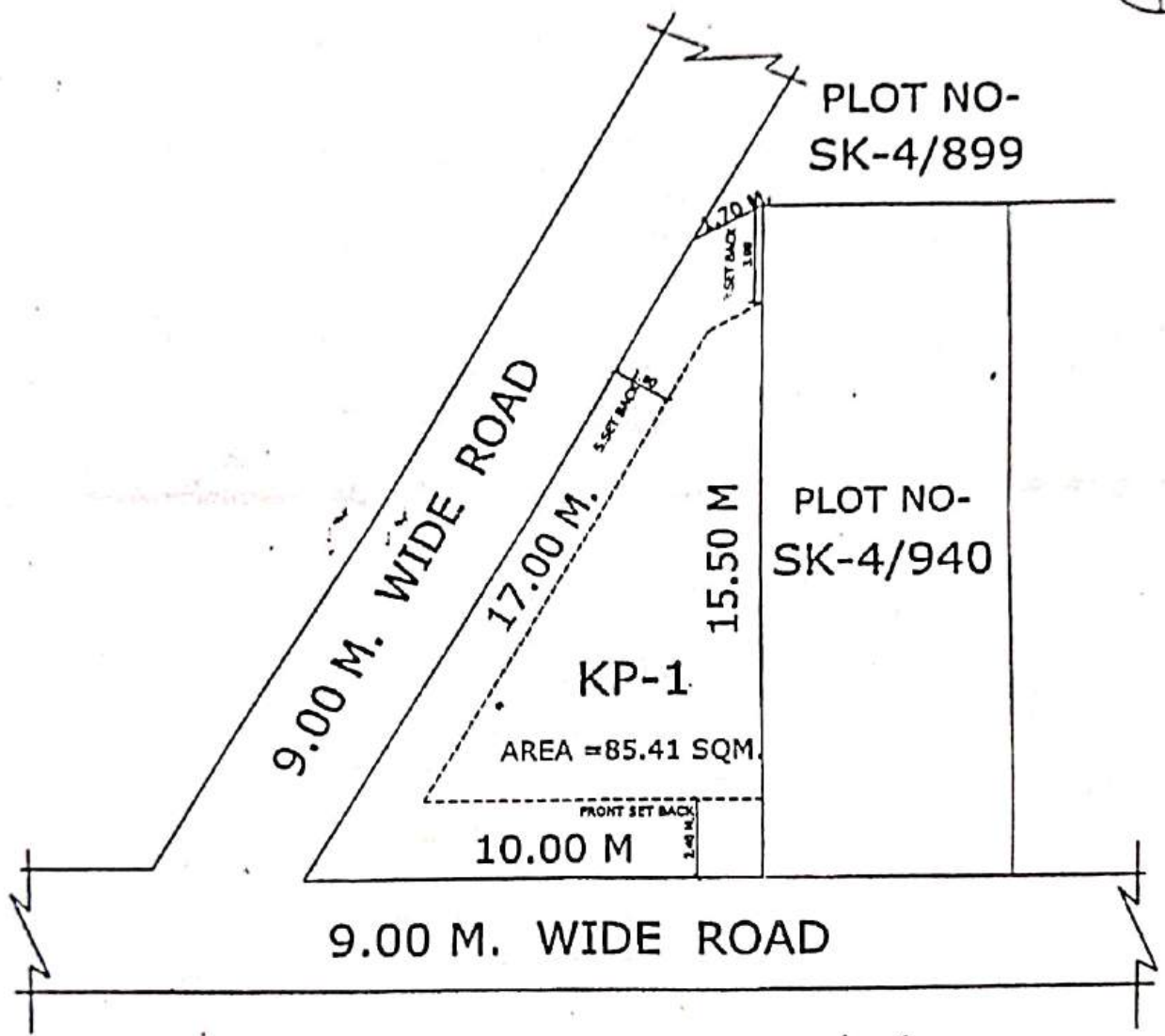

**SITE PLAN OF KIOSK PLOT NO KP-1 SHAKTI KHAND-4 IN  
INDRAPURAM SCHEME G.M.P GHAZIABAD**

TOTAL AREA OF KIOSK PLOT NO = 85.41 SQM.

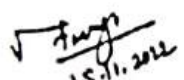

  
D/M

  
15.11.2012  
J.E.

  
A.E.

  
E.E.-6

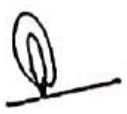
  
T.P.

  
C.A.T.P.

  
SECY.



SITE PLAN OF POLICE CHOWKI PLOT, COMMUNITY CENTER PLOT & PRI. SCHOOL PLOT AT  
POCKET-B MADHUBAN BAPUDHAM YOJNA , GDA, GZB.

PRI. SCHOOL PLOT - B/P.S.-1 = 1567.68 SQ.M. ✓

COMM. CENTER PLOT - B/C.C.-1 = 2832.56 SQ.M.

POLICE CHOWKI PLOT - B/P.C.-1 = 3098.30 SQ.M.

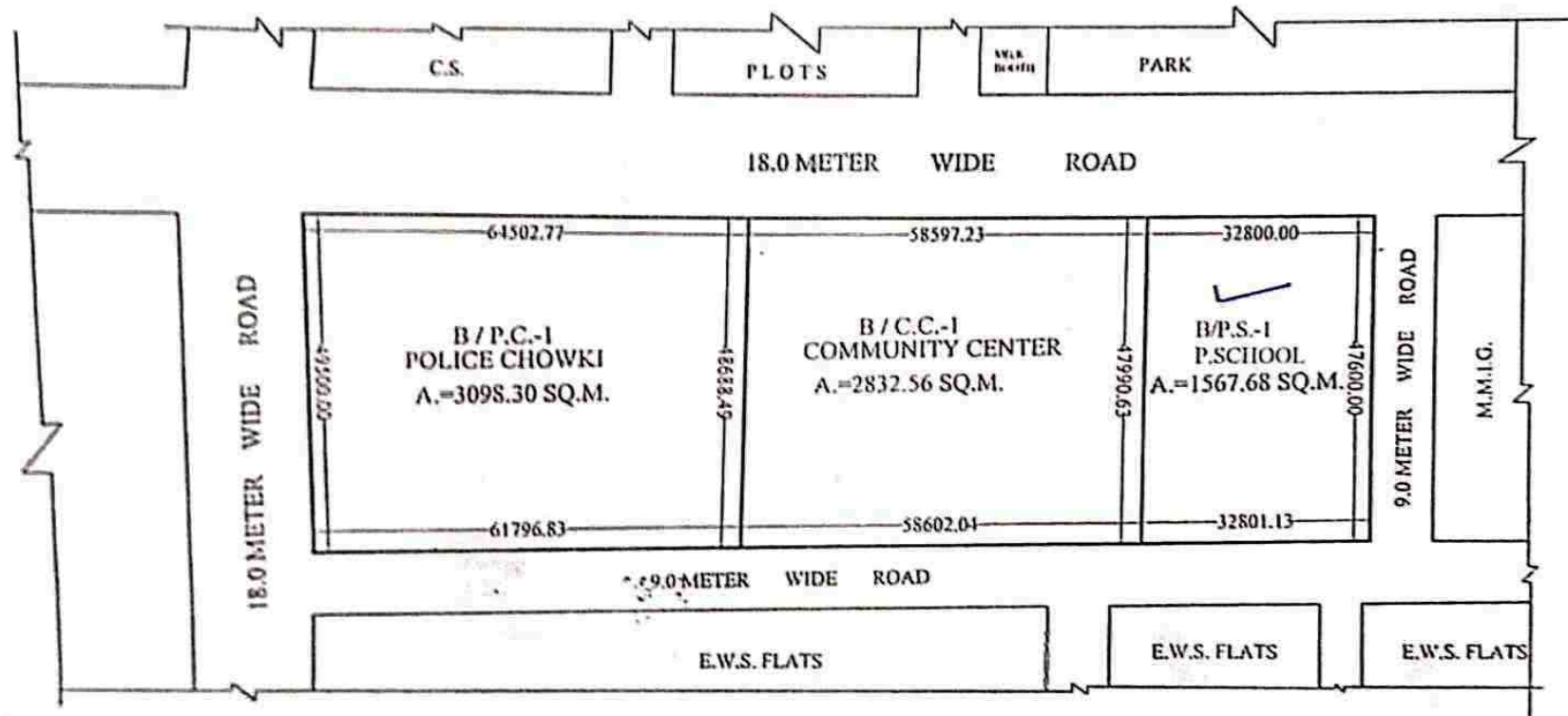

*Admani*  
11-02-21

PREPARED BY

*Arund*  
25/02/21

COMPARED BY

*meas*

MEAS.&AREA CAL.(J.E.)

*Arund*

A.E.

*Arund*

E.E.

*Arund*

TOWN PLANNER

PLAN OF PRIMARY SCHOOL PLOT NO. D/P.S.-1 AT POCKET 'D' MADHUBAN BAPUDHAM YOJNA; GZB.  
AREA OF PRI. SCHOOL D/P.S.-1= 1375.00 SQ.M.

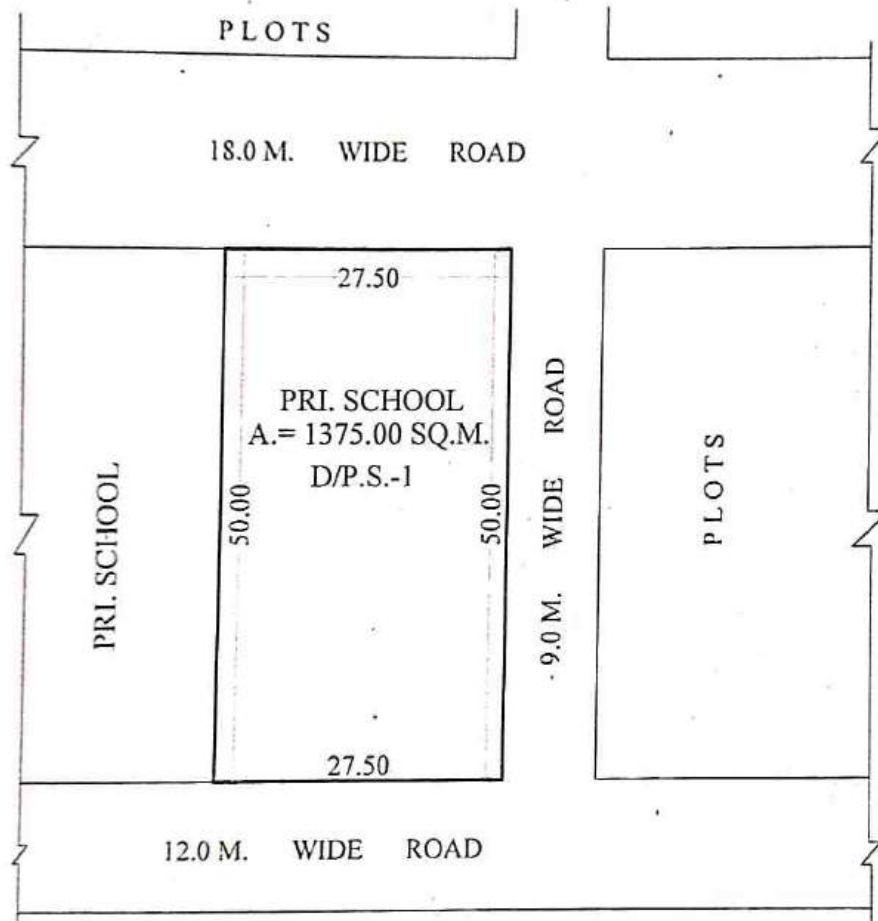

*Shweta*  
06-01-2021  
PREPARED BY

*Shweta*  
06/01/21  
COMPARED BY

*[Signature]*  
(MEAS. & AREA CAL.) E.

*[Signature]*  
A.E.

*[Signature]*  
E.E.

*[Signature]*  
T.P.



# गाजियाबाद विकास प्राधिकरण



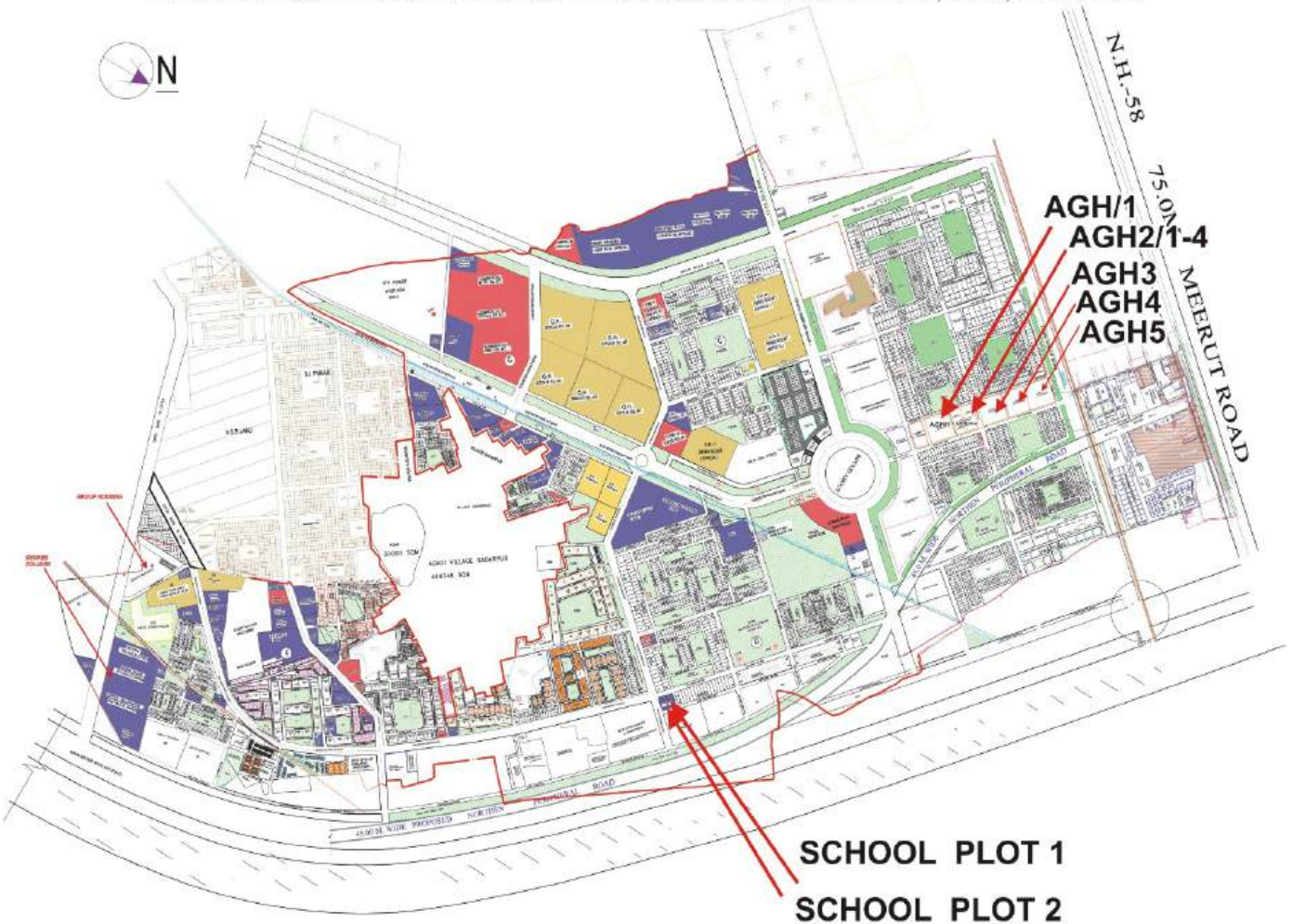



REVISED LAYOUT PLAN OF MADHUBAN-BAPUDHAM RESIDENTIAL SCHEME , G.D.A;GHAZIABAD.

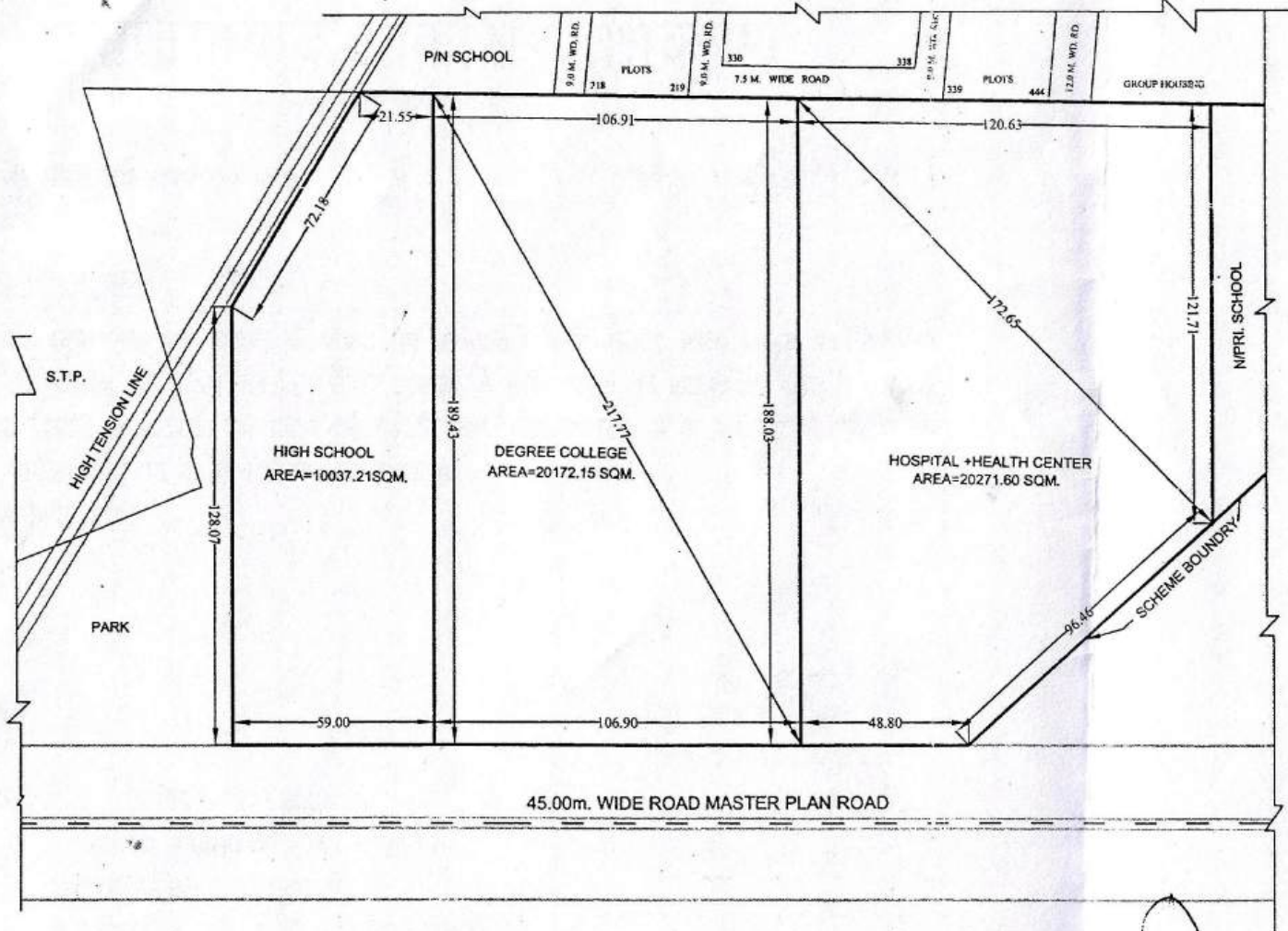

LAN FOR HIGH SCHOOL , DEGREE COLLEGE & HOSPITAL+HEALTH CENTER PLOT AT POCKET- F MADHUBAN BAPUDHAM YOJNA;GDA, GZB

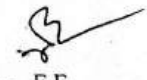
- HIGH SCHOOL PLOT = 10037.21 SQ.M.
- DEGREE COLLEGE PLOT = 20172.15 SQ.M.
- HOSPITAL+HEALTH CENTER PLOT = 20271.60 SQ.M.

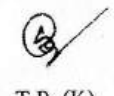

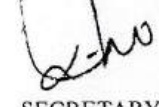
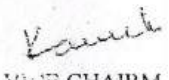
 AMIN  
 J.E.  
 A.E.  
 E.E.  
 O.S.D. (LA)  
 T.P. (R)  
 T.P. (K)  
 C.A.T.P.  
 SECRETARY  
 VICE CHAIR

H.C. / C.C.

match (8)

# PROPOSED PART LAYOUT PLAN AT SECTOR VI VAISHALI :

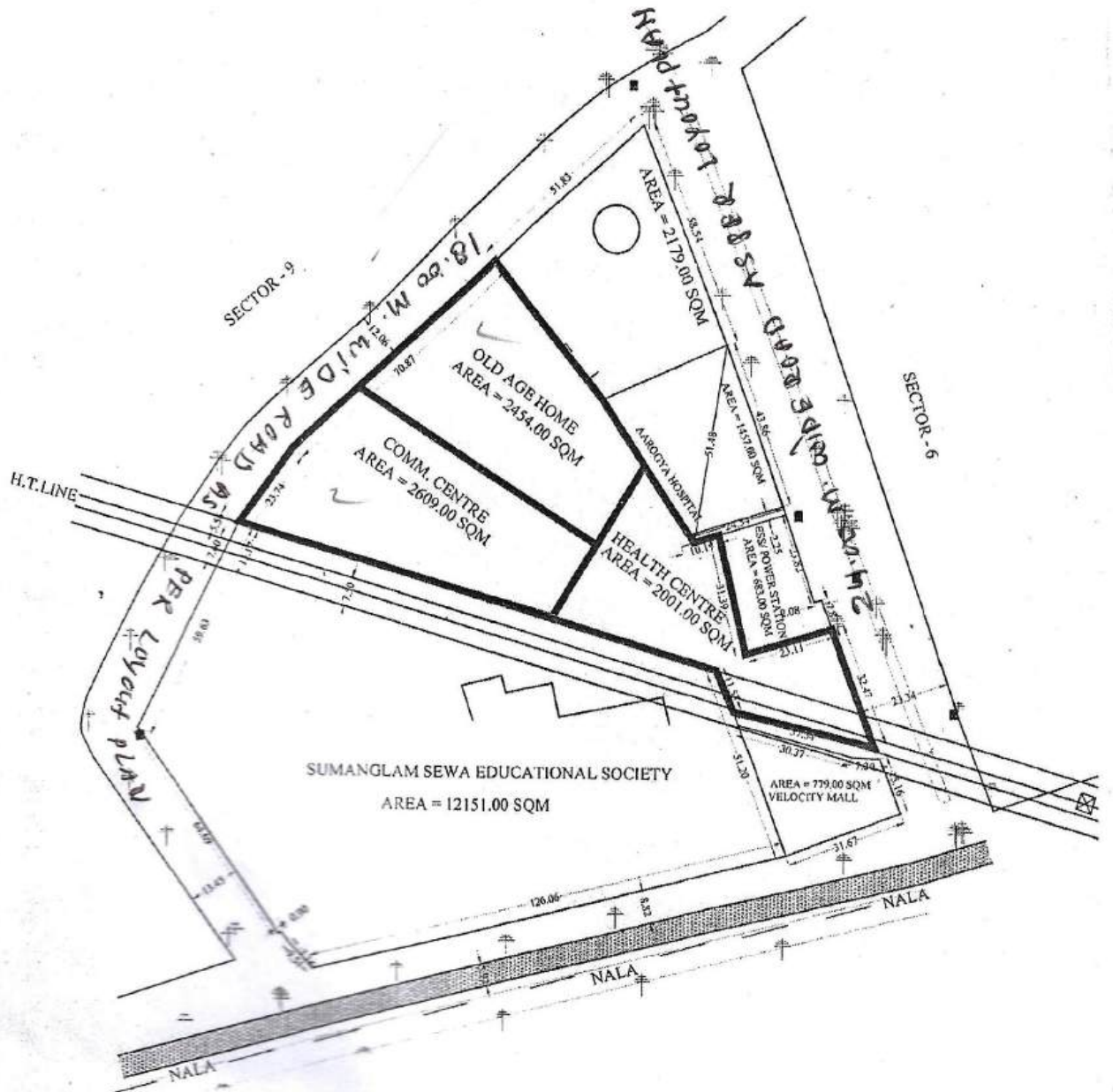

D/MAN J.E. A.E. E.E. T.P. C.A.T.P. S

PROPOSED SITE FOR NURSING HOSTEL PLOT NO. E/N.HS.-1 IN POCKET-E, AT MADHUBAN BAPUDHAM YOJNA.G.D.A. GZB.

AREA OF NURSING HOSTEL PLOT NO. E/N.HS.-1 = 10408.59 SQ.M.

21/06/2020

S.No - 14

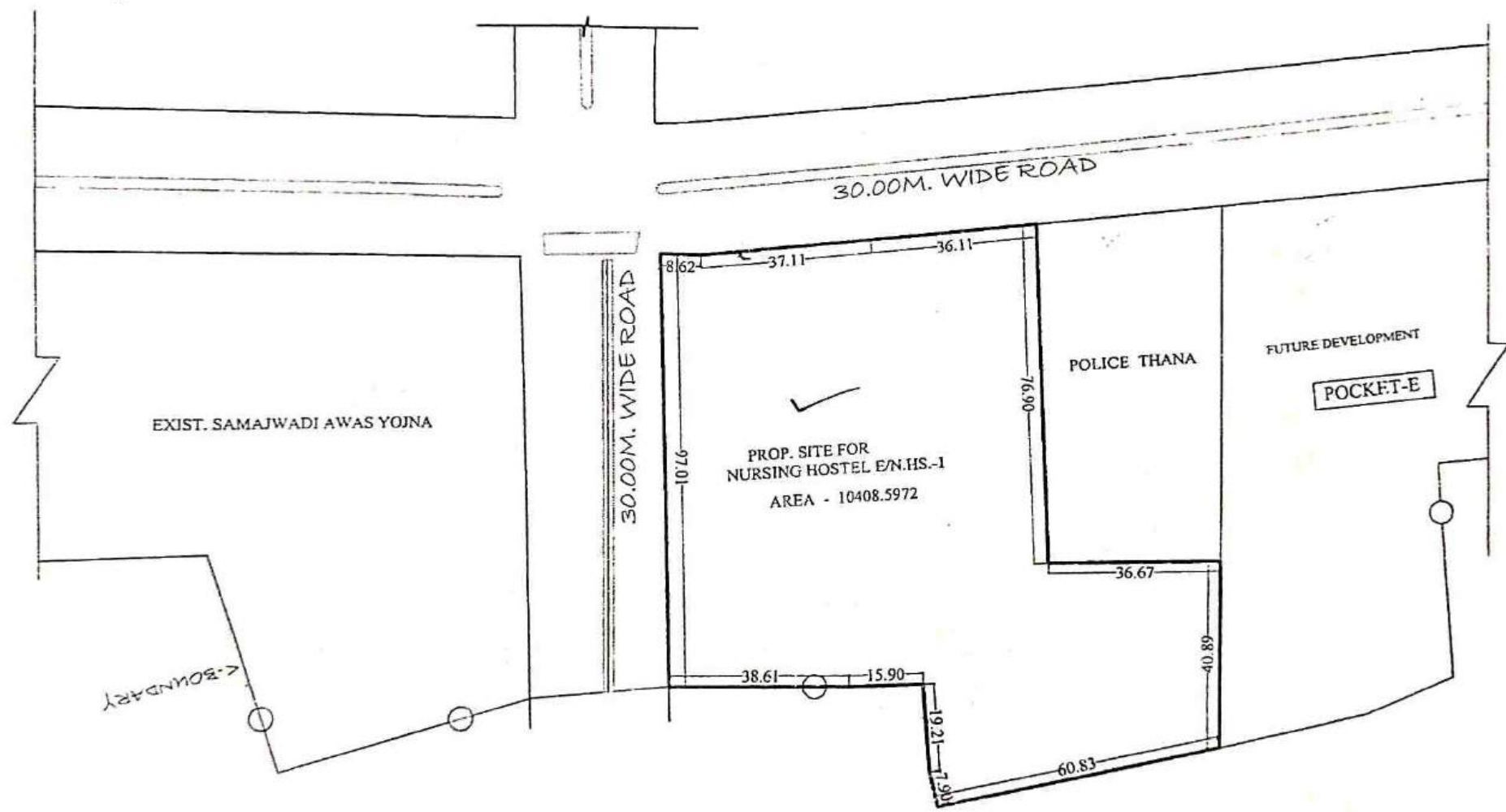

Tentative Site Plan

21/06/2020  
AN AMIN

JE

JE

OSD-LA

EE

TP(R)

TP(K)

SECRETARY

VICE CHAIRMAN

# SITE PLAN OF BANK PLOT NO. B/BK-1 & B/BK-2 AT B-BLOCK SECTOR - XI GMP PRATAP VIHAR GZB..

AREA OF PLOT NO. B/BK-1 - 274.505 SQ.M.  
 AREA OF PLOT NO. B/BK-2 - 274.505 SQ.M.



**USEAGE :**

BASEMENT - PARKING  
 GROUND FL.- COMM/OFF  
 FIRST FL. - BANK  
 SECOND FL. - COMM. / OFF.

GR. COV. - 40%  
 F.A.R. - 1.20

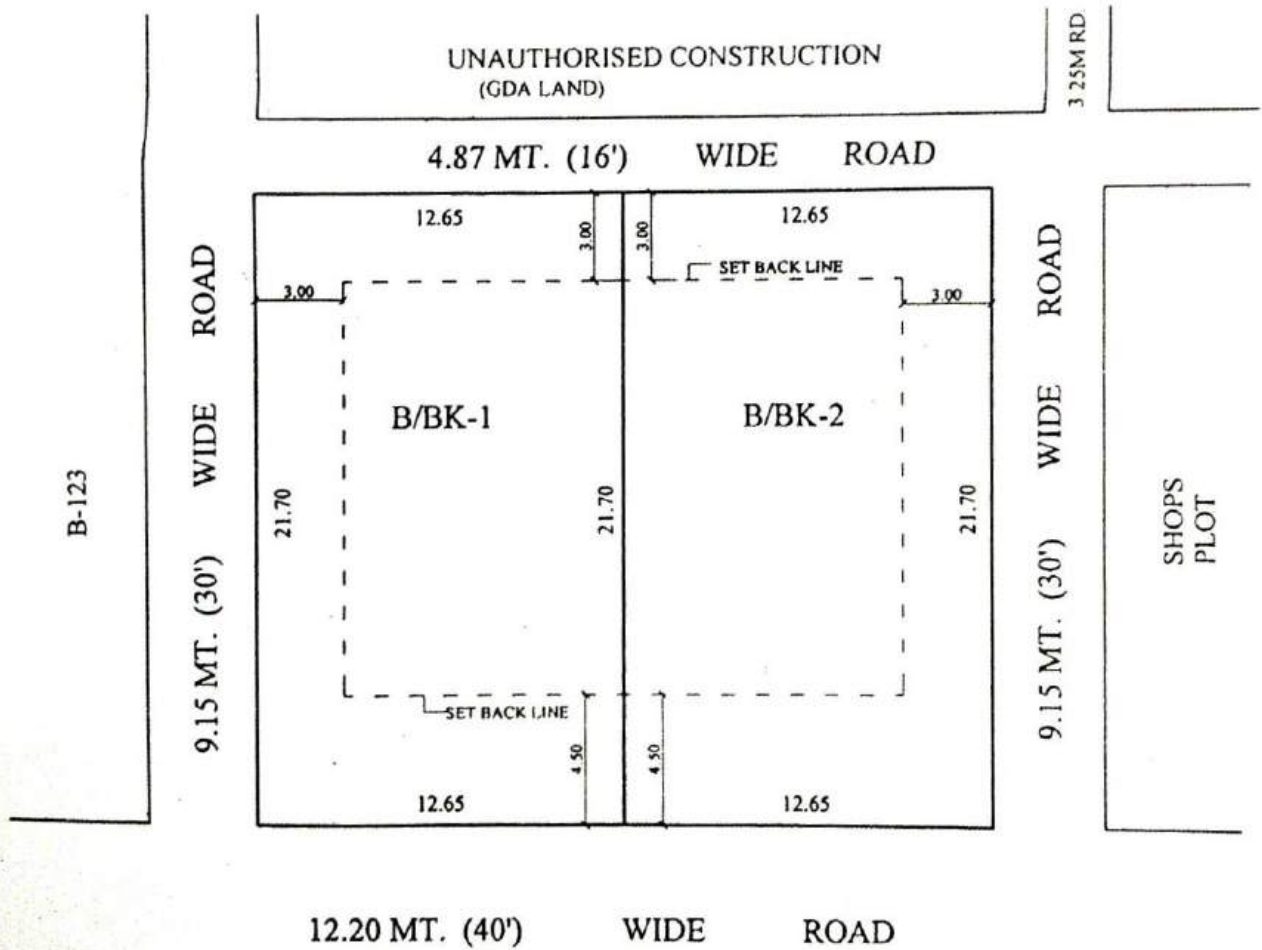

04/09/13  
 MAN  
 J.E. SA  
 J.E.

E/19762  
 A.E.  
 E.E.  
 T.P.

M  
 C.A.T.P.  
 SECY.



# SITE PLAN FOR KIOSK IN "D" BLOCK PATEL NAGAR, SECTOR - 7 G.M.P. GHAZIABAD

Scale - 1:500

AREA OF KIOSK LAND = 116.84 Sqm.



*[Signature]*  
22/4/08

Prepared By.

*[Signature]*  
22/4/08

Compared By.

*[Signature]*  
22/4/08

Measured By.

*[Signature]*  
22/4/08

Astt. Engineer

*[Signature]*  
23/4/08

A.T.P.

*[Signature]*  
Town Planner.

# SITE PLAN OF CORPORATE OFFICE / CLUB PLOT AT BLOCK - P, SECTOR -12, PRATAP VIHAR, GHAZIABAD





TOTAL AREA = 3497.90SQM  
FOR TUBEWELL = (-) 225.00SQMT  
BALANCE AREA = 3272.90SQM

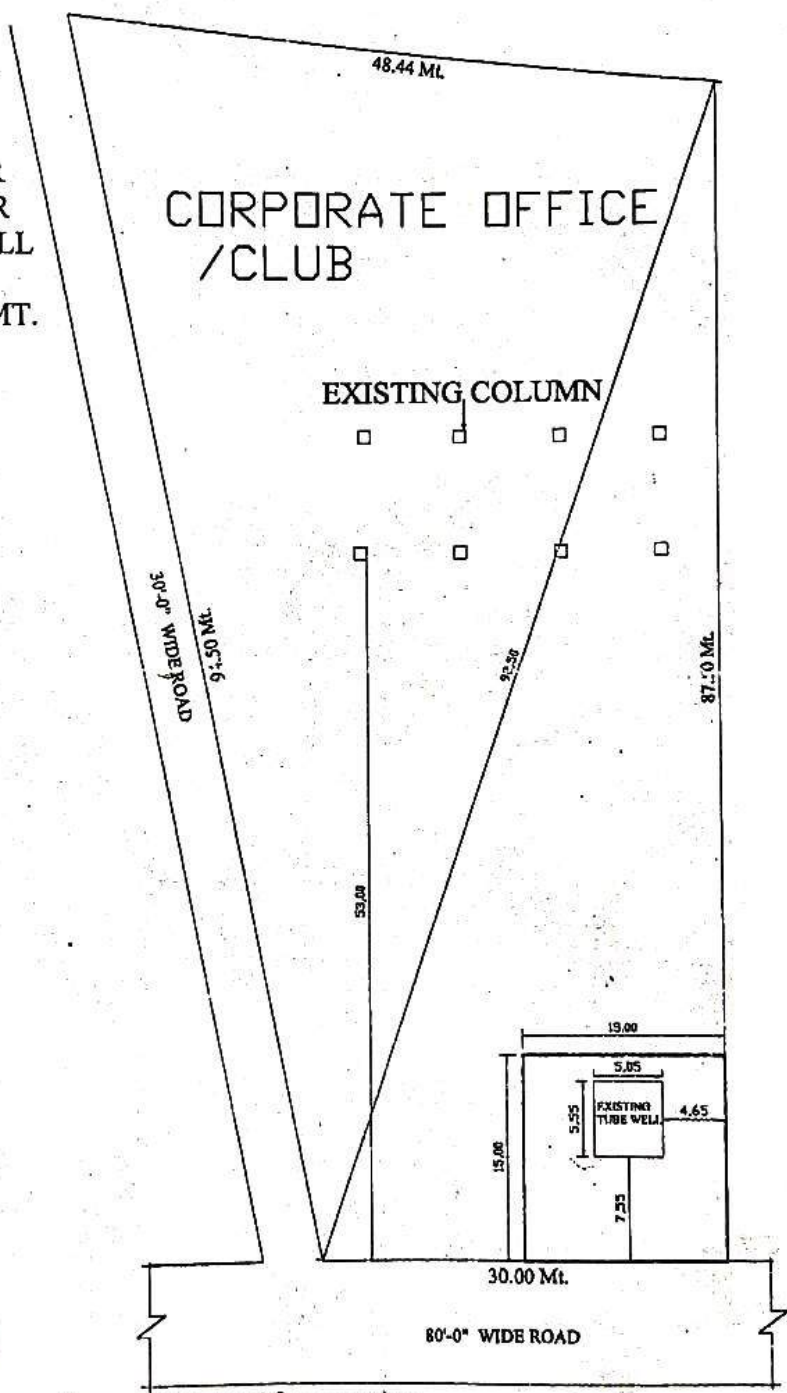

PROPOSED LAND FOR  
TRANSFER TO NAGAR  
NIGAM FOR TUBEWELL  
ROOM.  
15.0 X 15.00M=225 SQMT.

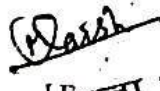

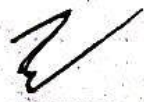
- नोट -
1. भूखण्ड पर निर्मित कॉलमों का ध्वस्तीकरण आर्कटी द्वारा रचय किया जाना होगा।
  2. जहाँ है, जैसा है के आधार पर नीलागी किया जाना होगा।

अधर अभियन्ता      आर. के. सिंह  
 राज वशिष्ठ      अध्यापकी अभियन्ता  
 ए. ए.      टी. पी.  
 सी. ए. टी. पी.      सेक.

10 ए. ए. 10 मंडरा  
 आवासीय अभियन्ता

TOTAL PLOT AREA=142.32 SQM.

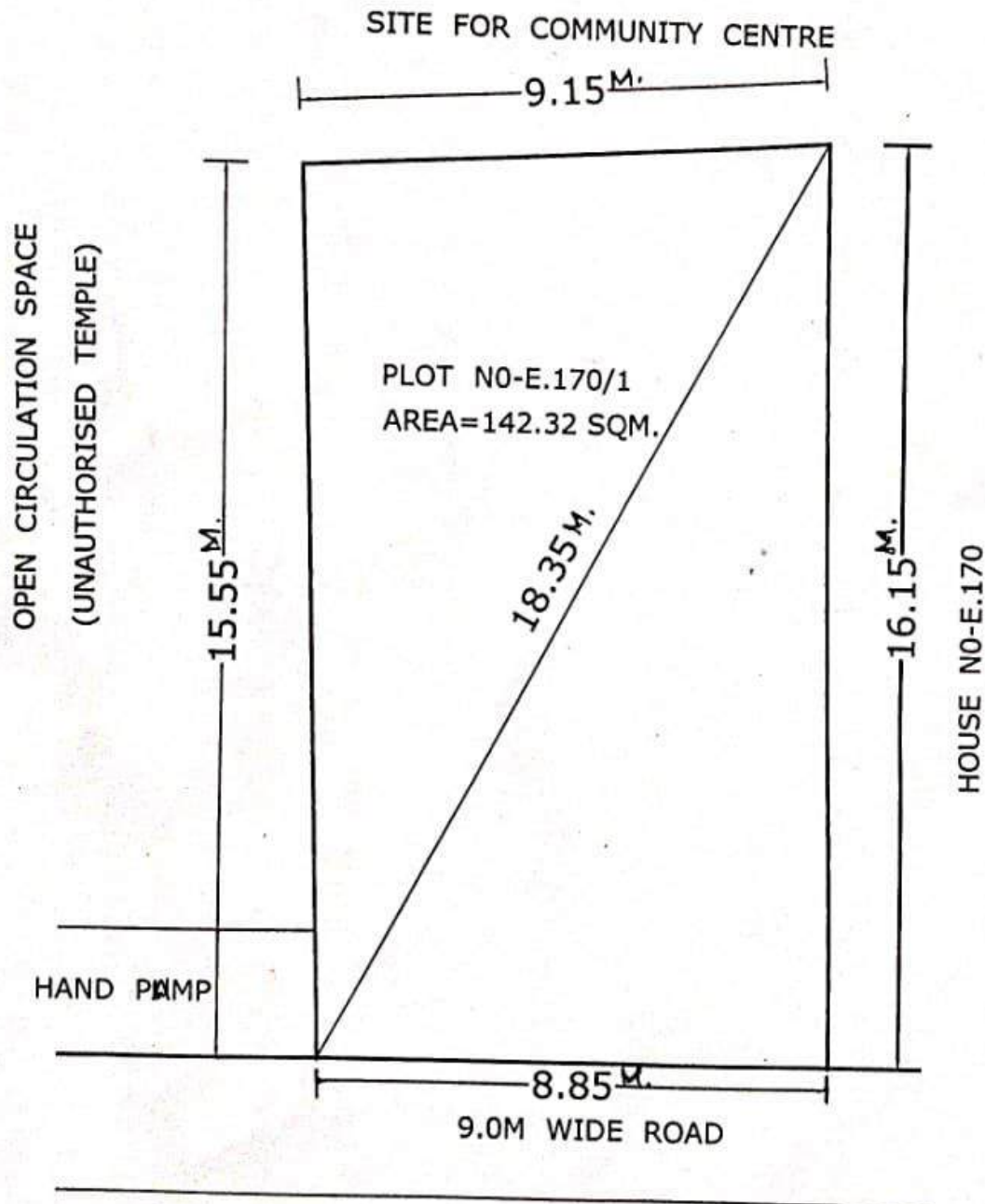

*[Signature]*  
24/10/12  
D/MAN

*[Signature]*  
24/10/12  
TOWN PLANNER

*[Signature]*  
C.A.T.P

*[Signature]*  
SECRETARY

*[Signature]*  
VICE CHAIRMAN

# REVISED SITE PLAN OF CONVENIENT SHOP PLOTS SK-IV/C.S.-1 TO C.S.-5 & VENDING ZONE AT SHAKTI KHAND - IV INDIRAPURAM GHAZIABAD.

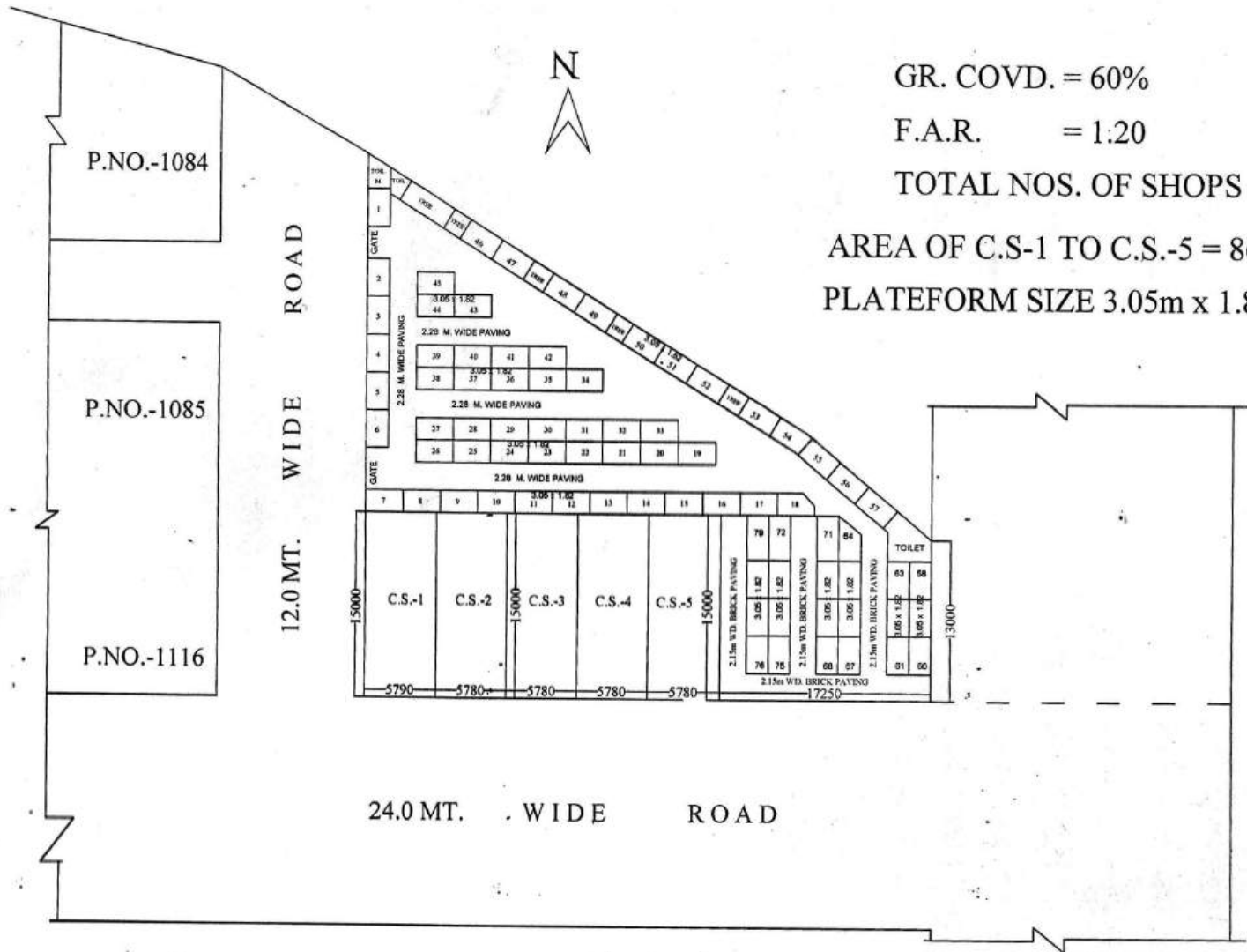

GR. COVD. = 60%

F.A.R. = 1:20

TOTAL NOS. OF SHOPS = 05

AREA OF C.S.-1 TO C.S.-5 = 86.70 SQ.M.

PLATFORM SIZE 3.05m x 1.82m

D.MAN

J.E.

A.E.

A.T.P.

E.E.

T.P.

C.A.T.P.

SECRY

V.C.

REVISED SITE PLAN OF PLOT NO. SK-94 IN SHASTRI NAGAR SECTOR-XVI GZB.

AREA OF PLOT SK-94 = 358.65 SQ.M.

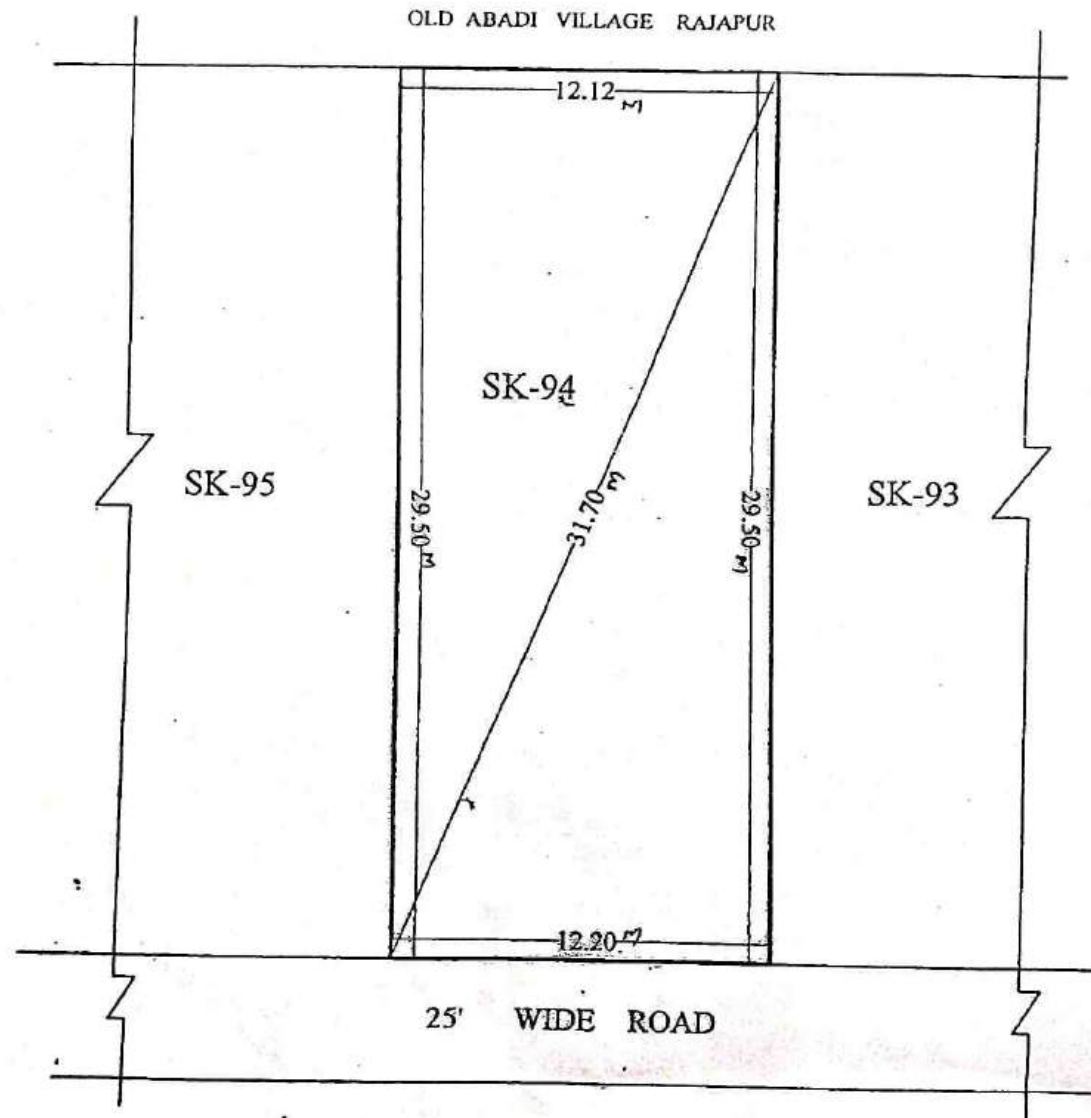

  
16/02/18  
PREPARED BY.

  
22-02-18  
COMPARED BY.

J.E.(MEAS.& AREA CAL BY)

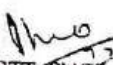
  
12-2-18  
ASST ENGR.

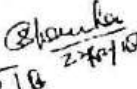
  
2-2-18  
EE.

  
A.T.P.

  
TOWN PLANNER

AT TULSI NIKETAN SCHEME THA IN GHAZIABAD

SCALE : 1 CM = 5 Mts.

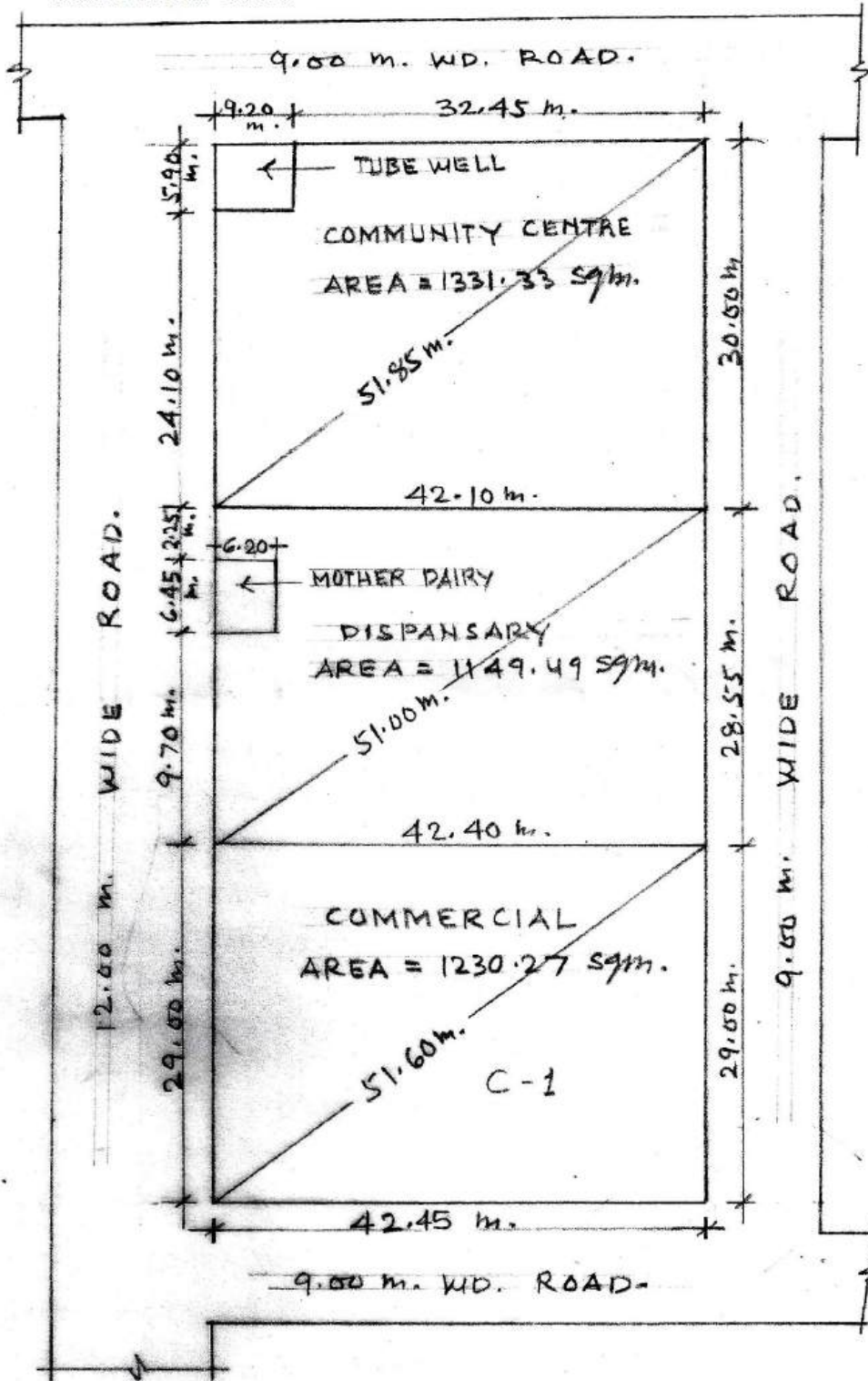

*Ahmed*  
10/01/07

*Salim*  
11/01/07

*Ammy*  
22/01/07

*Flow*  
22/01/07

*X/1900*  
21/01/07

PREPARED BY COMPARED BY MEASURED BY ASST ENGR. TOWN PLANNER

TE PLAN OF SHOP NO. - <sup>श्री 204</sup> POCKET - B, AT SCHEME NO. - 10, DELHI UP BORDER  
 SCHEME ON KHASRA NO. - 3,4 & 10 VILLAGE CHIKAMBAR PUR, G.T. ROAD GHZIABAD.

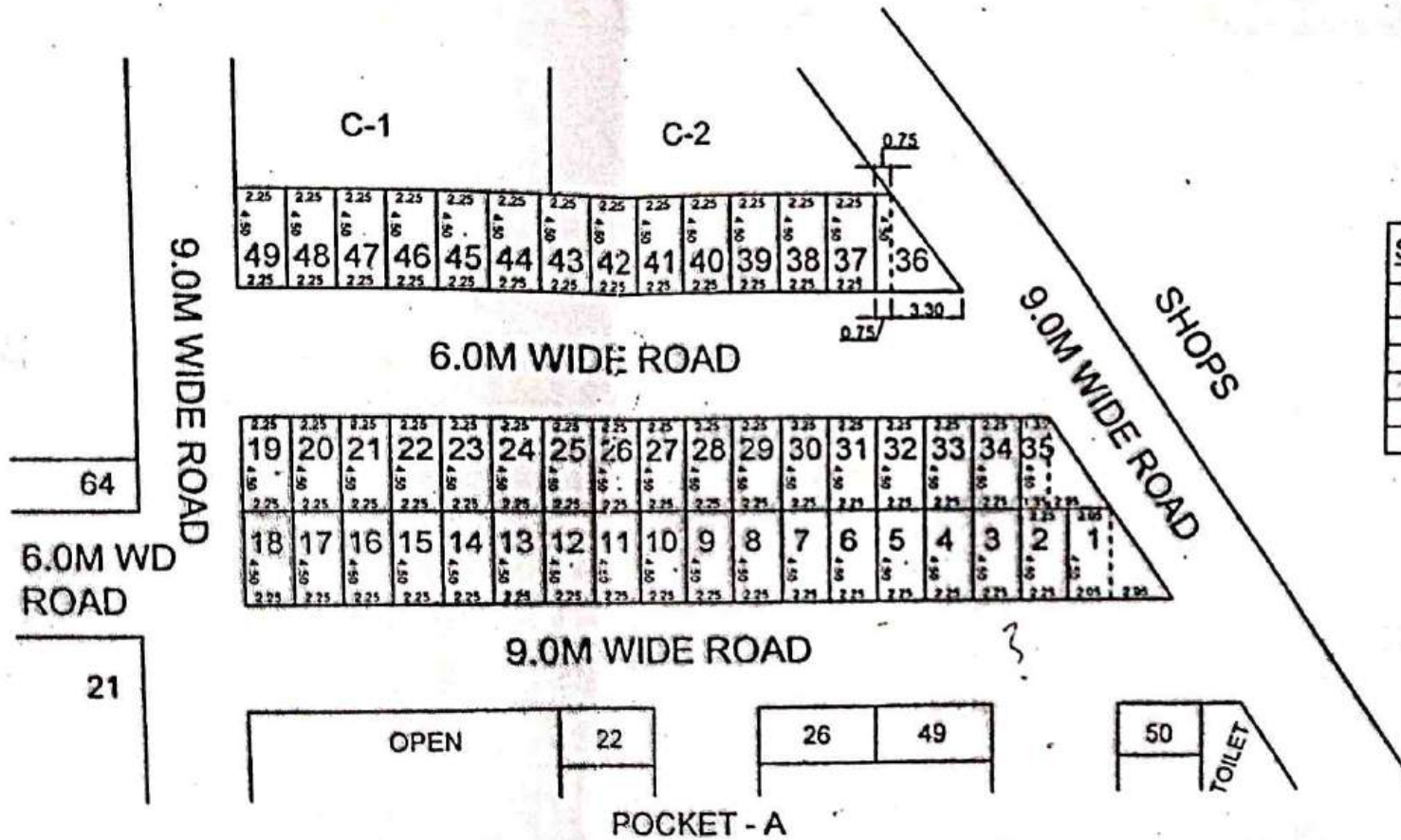

SHOPS PLOT AREA DETAIL	
SHOPS PLOT No.	AREA (Sq.m.)
1	15.862
2 TO 34	10.125
35	12.712
36	10.80
37 TO 49	10.125

*[Signature]*  
 17/01/19  
 Prepared By

*[Signature]*  
 20/04/19  
 Compared By

*[Signature]*  
 J. Engr. (MEAS. & AREA CAL. BY)

*[Signature]*  
 Astt. Engg.

*[Signature]*  
 T.P.

प्लान अर्धी मे क्रमांक - 200 से 294

**SITE PLAN OF SHOP NO. - , POCKET - A, AT SCHEME NO. - 10, DELHI UP BORDER SCHEME ON KHASRA NO. - 3,4 & 10 VILLAGE CHIKAMBAR PUR, G.T. ROAD GHZIABAD.**

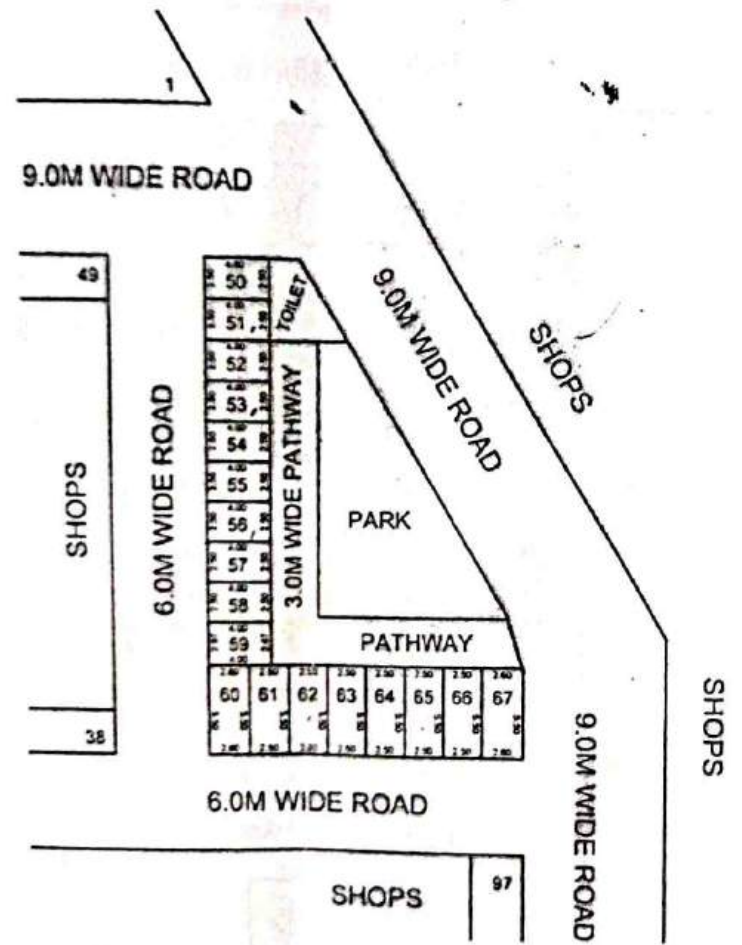

SHOPS PLOT AREA DETAIL	
SHOPS PLOT No.	AREA (Sq.m.)
50 To 58	10.00
59	10.68
60 & 67	14.30
61 To 66	13.75

*Handwritten signature*  
Prepared By  
21/06/19

*Handwritten signature*  
Compared By  
02-07-19

*Handwritten signature*  
J.ENGR.(MEAS. & AREA CAL. BY)

*Handwritten signature*  
Asth. Engg.  
7/07/19



प्लान मुचा से कम्पक

3033304

SITE PLAN OF SHOP NO. - , POCKET - A, AT SCHEME NO. - 10, DELHI UP BORDER SCHEME ON KHASRA NO. - 3,4 & 10 VILLAGE CHIKAMBAR PUR, G.T. ROAD GHZIABAD

SHOPS



9.0M WIDE ROAD.

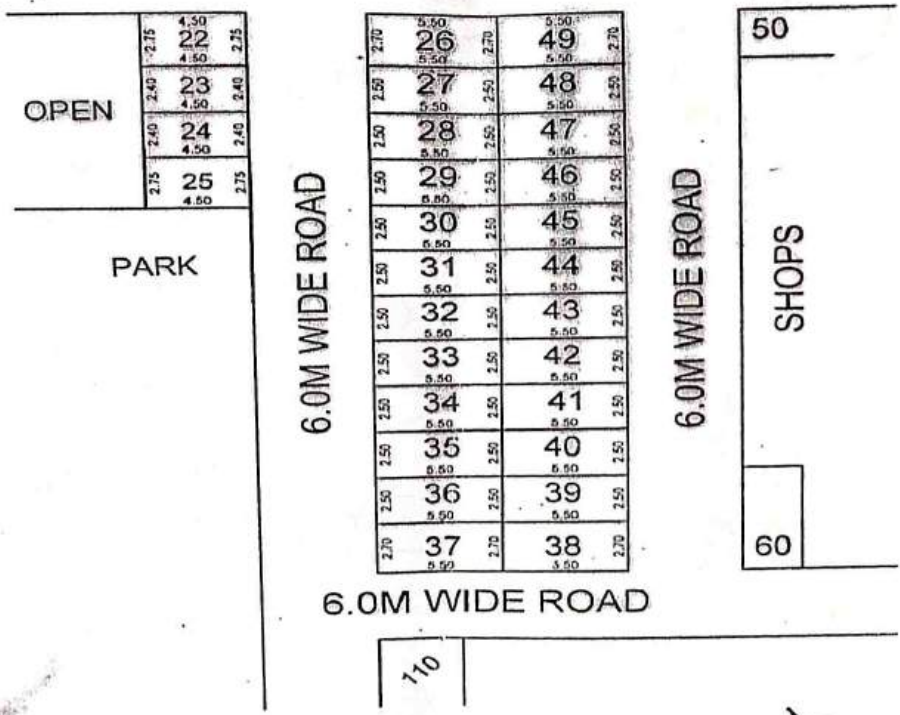

SHOPS PLOT AREA DETAIL	
SHOPS PLOT No.	AREA (Sq.m.)
22 & 25	12.375
23 & 24	10.80
26 & 37, 38 & 49	14.85
27 TO 36, 39 TO 48	13.75

*[Signature]*  
17/11/19  
Prepared By

*[Signature]*  
20/04/19  
Compared By

*[Signature]*  
J. Engr.(MEAS. & AREA CAL. BY)

*[Signature]*  
Astt. Engg.

*[Signature]*  
T.P.

REVISED PART LAYOUT PLAN OF SCHEME NO.-10 DELHI - U.P. BORDER ON KIJASRA NO.-3, 4 & 10 AT  
CHIKAMBAR PUR ON G.T. ROAD GHAZIABAD

DETAIL OF SHOP PLOTS IN POCKET - A

S.NO	TYPE	SIZE	AREA	PLOT NO.	NOS
1	I	2.5M X 5.5M	13.75 SQ.M. (148.00 SQ.FT.)	S-26 TO 49, S-60 TO 61 S-87A, 88 TO 124,	79
2	II	2.4M X 5.3M	12.72 SQ.M. (136.91 SQ.FT.)	S-18, 19, 20, 20A, B, C, D, E, 21	09
3	III	2.4M X 4.85M	11.64 SQ.M. (125.23 SQ.FT.)	S-9, TO 17	09
4	IV	2.4M X 4.5M	10.80 SQ.M. (116.25 SQ.FT.)	S-1 TO 7, 7A, 8, 22 TO -25	09
5	V	2.5M X 4.0M	10.00 SQ.M. (107.64 SQ.FT.)	S-50 TO S-59, S-68 TO 87	39
<b>TOTAL SHOPS PLOTS</b>					<b>127</b>
1	COMM.		324.90 SQ.M.	C-1	01
2	COMM.		142.00 SQ.M.	C-2	01
3	COMM.		258.87 SQ.M.	C-3	01

DETAIL OF SHOP PLOTS IN POCKET - B

S.NO.	TYPE	SIZE	AREA	PLOT NO.	NOS.
1	I		55.0 SQ.M. (592.02 SQ.FT. approx.)	S-93 TO 99	07
2	II	3.0M X 6.0M	18.00 SQ.M. (193.75 SQ.FT.)	S-80 TO 92	13
3	III	2.5M X 5.5M	13.75 SQ.M. (148.00 SQ.FT.)	S-50 TO 79	30
4	IV	2.25M X 4.5M	10.125 SQ.M. (108.98 SQ.FT.)	S-01 TO 49	49
	V	2.5M X 4.0M	10.00 SQ.M. (107.64 SQ.FT.)	S-100 TO 123	24
<b>TOTAL SHOPS PLOTS</b>					<b>123</b>
5	COMMERCIAL		132.69 SQ.M. (1428.27 SQ.FT.)	C-1	01
6	COMMERCIAL		135.96 SQ.M. (1463.47 SQ.FT.)	C-2	01

नोट- पार्ट ले-आउट प्लान में दर्शित अनाधिकृत निर्माण (रोडेड पोरशन) से ग्रस्त भूमि पर प्रस्तावित नियोजन स्थल से नियमानुसार अनाधिकृत निर्माण करने के उपरान्त ही प्रभावी होगा।

D/MAN

AMIN

J.E.

A.E.

E.E-ZONE-8.

TEHSILDAR-L.A.

T.P.

C.A.T.P.

SEC./V.C.

V.C.

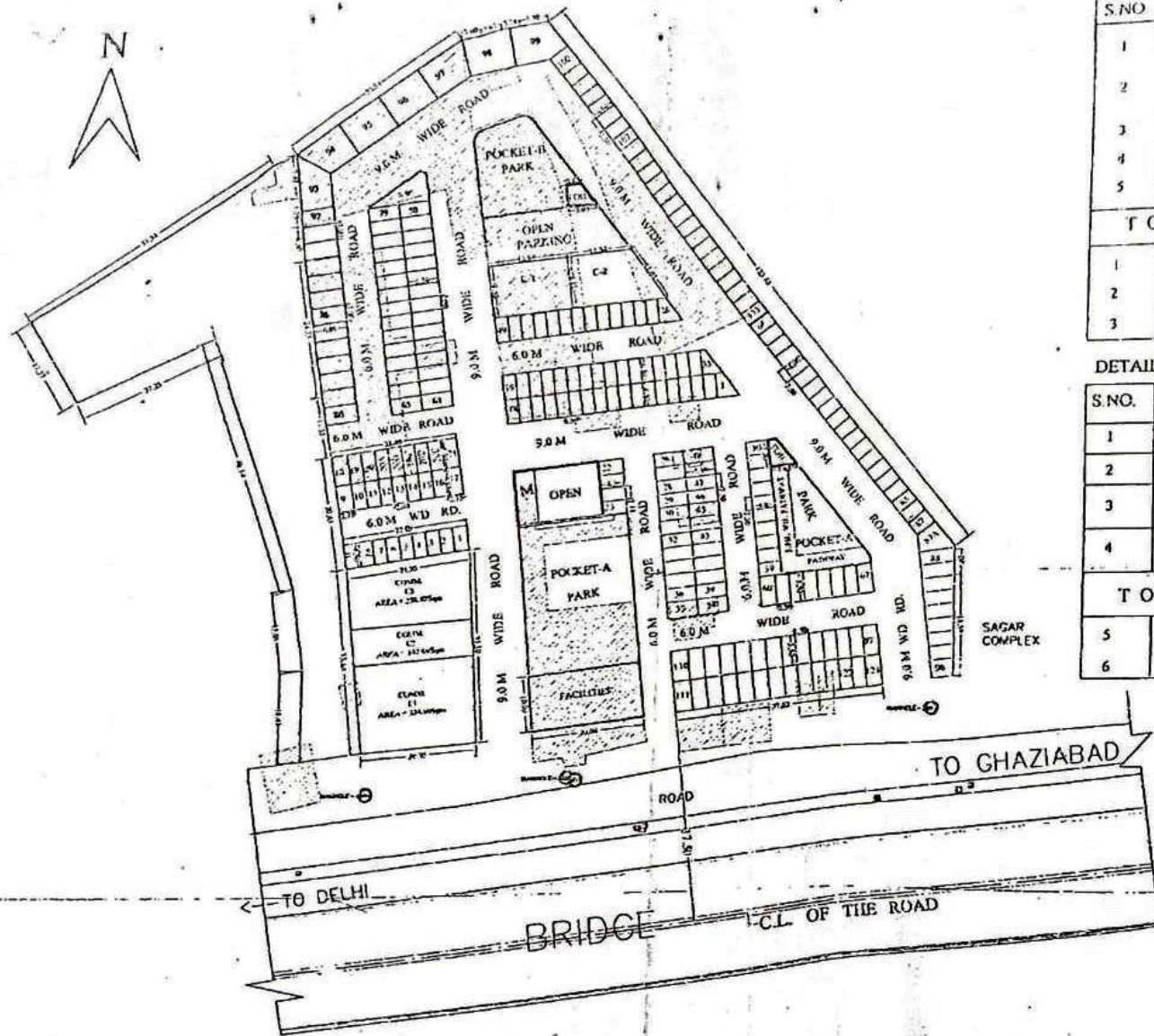

**SITE PLAN OF SHOP PLOT No. - , POCKET - A, SCHEME No. - 10, DELHI UP BORDER ON  
KHASRA No. - 3,4 & 10 AT CHIKAMBAR PUR ON G.T. ROAD GHZABAD.**

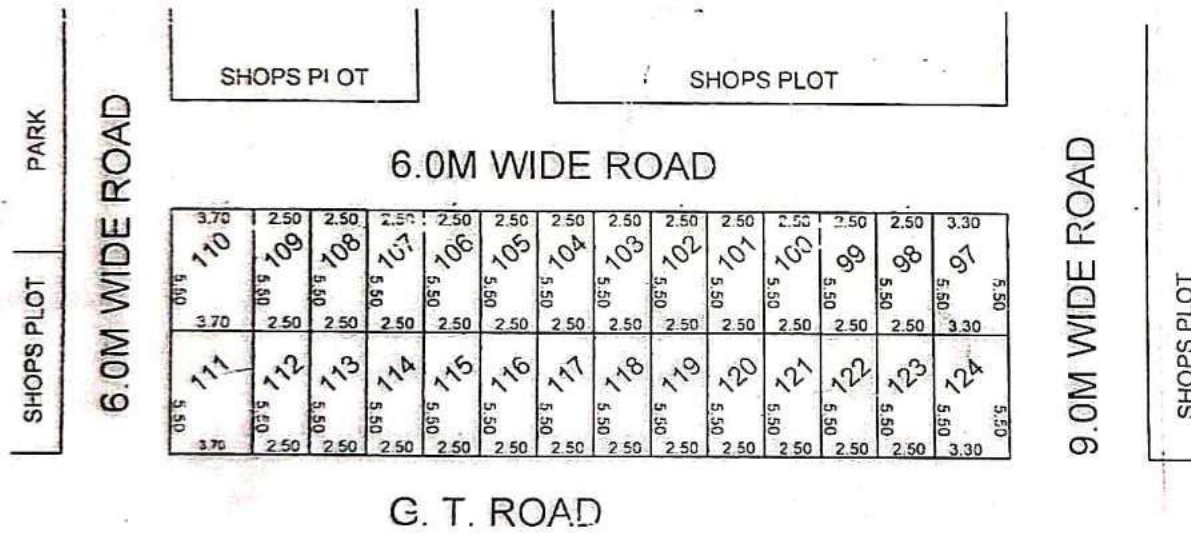
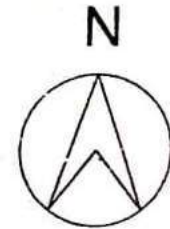

SHOPS PLOT No.	AREA (Sq.m.)
97	18.15
98 TO 109	13.75
110	20.35
111	20.35
112 TO 123	13.75
124	18.15

*[Signature]*  
15/05/17  
Prepared By

*[Signature]*  
16/5/17  
Compared By

*[Signature]*  
Measured & Area Cal. By

*[Signature]*  
Asth. Engh.

*[Signature]*  
18/5/17  
T.P.

**SITE PLAN OF HIGH SCHOOL PLOT CONVERT IN TO G.H / RESI.PLOT/POST OFFICE AT SECTER -3  
VAISHALI GHAZIABAD**

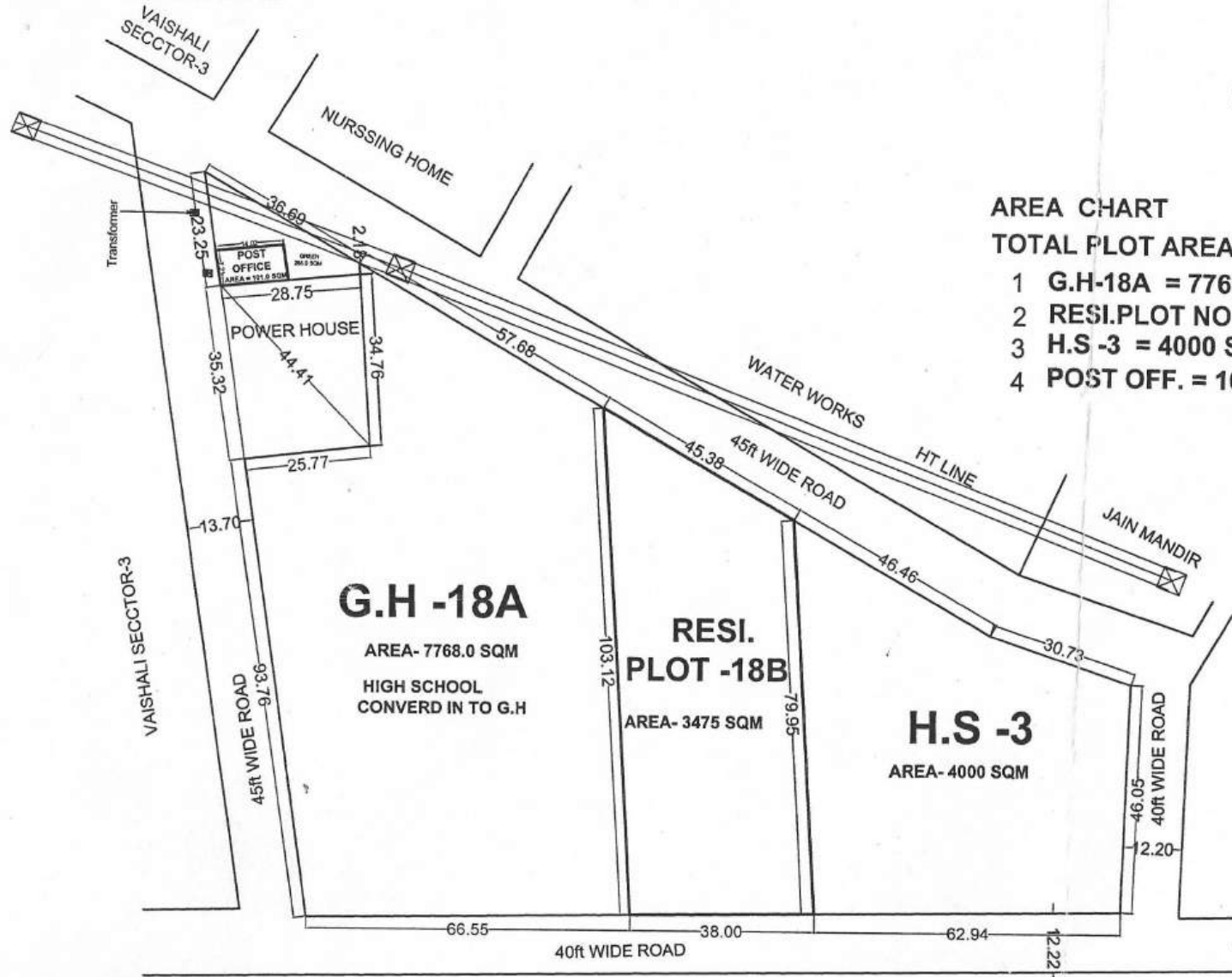

**AREA CHART**

**TOTAL PLOT AREA-15241 SQM**

- 1 G.H-18A = 7768.0 SQM
- 2 RESI.PLOT NO-18B = 3475 SQM
- 3 H.S -3 = 4000 SQM
- 4 POST OFF. = 101.0 SQM

**G.H -18A**

AREA- 7768.0 SQM  
HIGH SCHOOL  
CONVERD IN TO G.H

**RESI.  
PLOT -18B**

AREA- 3475 SQM

**H.S -3**

AREA- 4000 SQM

*[Signature]*  
2/10/16  
D/M.

*[Signature]*  
T.P.

*[Signature]*  
C.A.T.P

*[Signature]*  
2/10/16  
SECY.

*[Signature]*  
V.C

# REVISED SITE PLAN FOR COMMUNITY CENTER & NURSING HOME AT SECTER-3 VAISHALI, GHAZIABAD

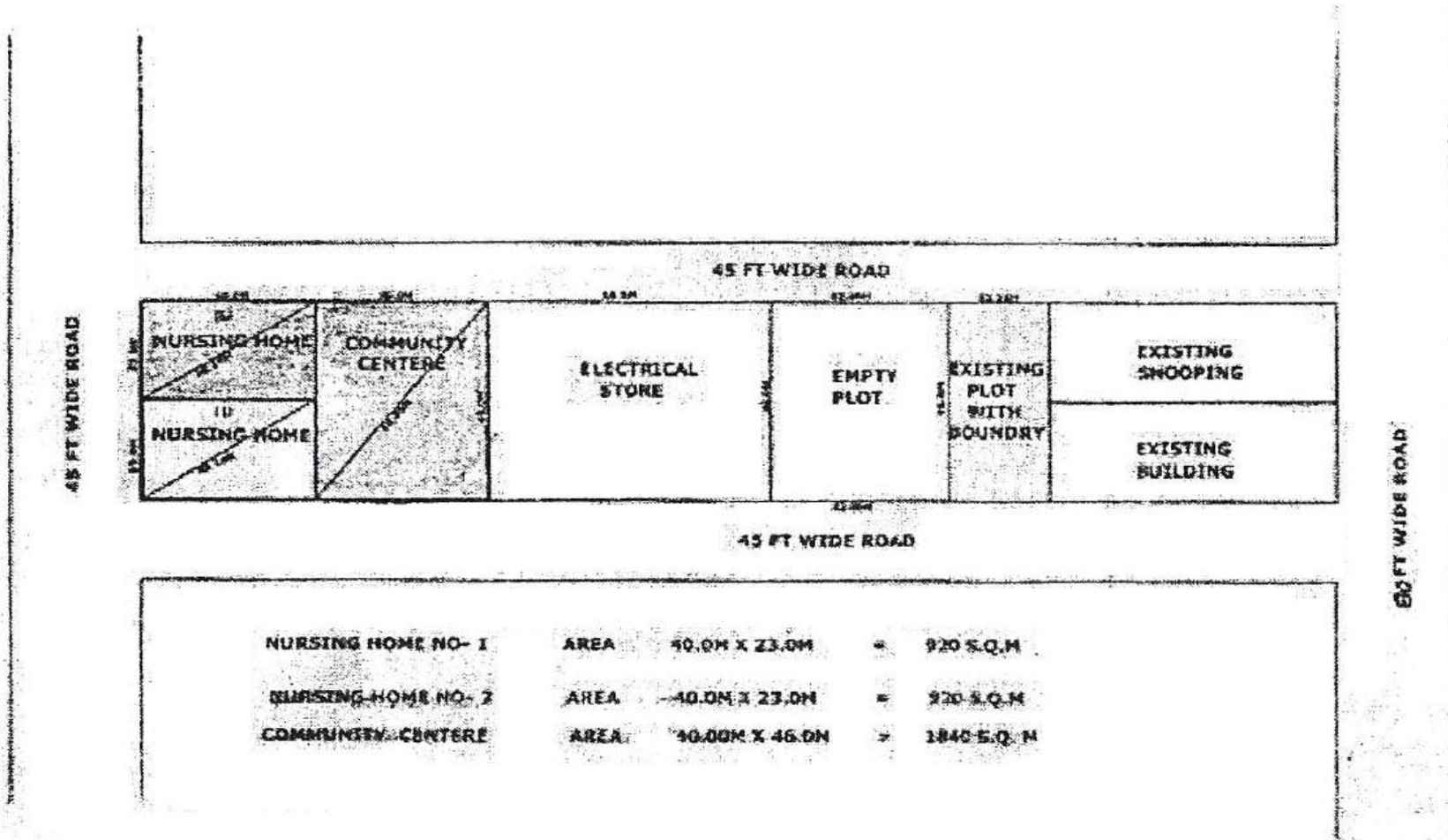

NURSING HOME NO- 1	AREA	40.0M X 23.0M	=	920 S.Q.M
NURSING HOME NO- 2	AREA	40.0M X 23.0M	=	920 S.Q.M
COMMUNITY CENTER	AREA	40.00M X 46.0M	=	1840 S.Q.M

 D/M  
 AMIN  
 J.E  
 A.E  
 E.E-6  
 IEM (LA)  
 T.D  
 S.H.P  
 SECRETARY  
